



DP PARTS REFERENCE GUIDE FOR CURRENT AND VINTAGE UNITS

HAND CONNECTION	page 2
DH / DHA UNITS	page 3
DV UNITS	page 4
BH / HBA UNITS - Blowers etc	page 5
BH / HBA UNITS - Coils	page 6
BV UNITS	page 8
BM / BMA UNITS	page 9
BR / BRC UNITS	page 10
DU-B UNITS	page 12
CH*/CEW-A Sizes 006 thru 036 UNITS	page 13
KV Units / HX, HW, VX, VW DRAINPANS	page 17
REPLACEMENT BELT DRIVE MOTORS	page 18
REPLACEMENT DRIVES / TOUCH UP PAINT	page 19
REPLACEMENT FILTERS	page 20
EXPANSION VALVES	page 21
Blowers prior to 1993 - Belt Drive	page 22
REPLACEMENT BELTS	page 23
STARTER/OVERLOAD	page 24
For newer models using our RPL System	
HBB / BVE / BMB / BRD	page 26
DHB / DVB / DUC / CHA / FF / FS	
MAP FOR FREIGHT CHARGES	page 27
NON-SUPPORTED PRODUCTS	page 28
UNIT CROSS REFERENCE	page 29

SEND ORDERS TO:

purchaseorders@magicaire.com

Lead Time 3 Days Except Where Noted

Items marked with "**SD**" ship same day if order received by 11:00am CST

All Parts Orders ship 2nd day Air unless Ground noted on Purchase Order

Orders Subject to \$50 net minimum

In the event of a stock outage, same day parts will ship in 3 days. Please confirm ship date at time of order by checking the automatic order acknowledgment or online order status.

FOR QUESTIONS PLEASE CONTACT customer.service@magicaire.com

SUBJECT TO STANDARD MAGIC AIRE TERMS AND CONDITIONS
United Electric Company 501 GALVESTON STREET, WICHITA FALLS, TEXAS 76301

Magic Aire defines hand connection by facing the filter section, air hitting the back of the head, left hand is on the left, right hand is on the right.

Note: This definition is specific to Magic Aire. Hand connection varies by manufacturer.

Horizontal AHU – Top View

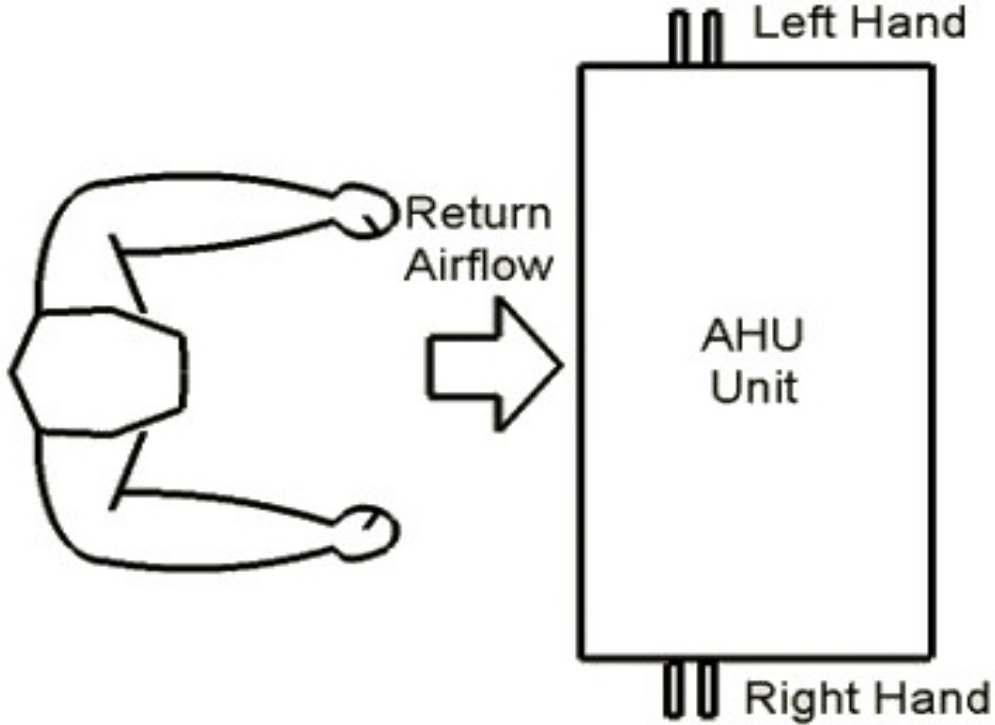

VERTICAL AHU – Top View

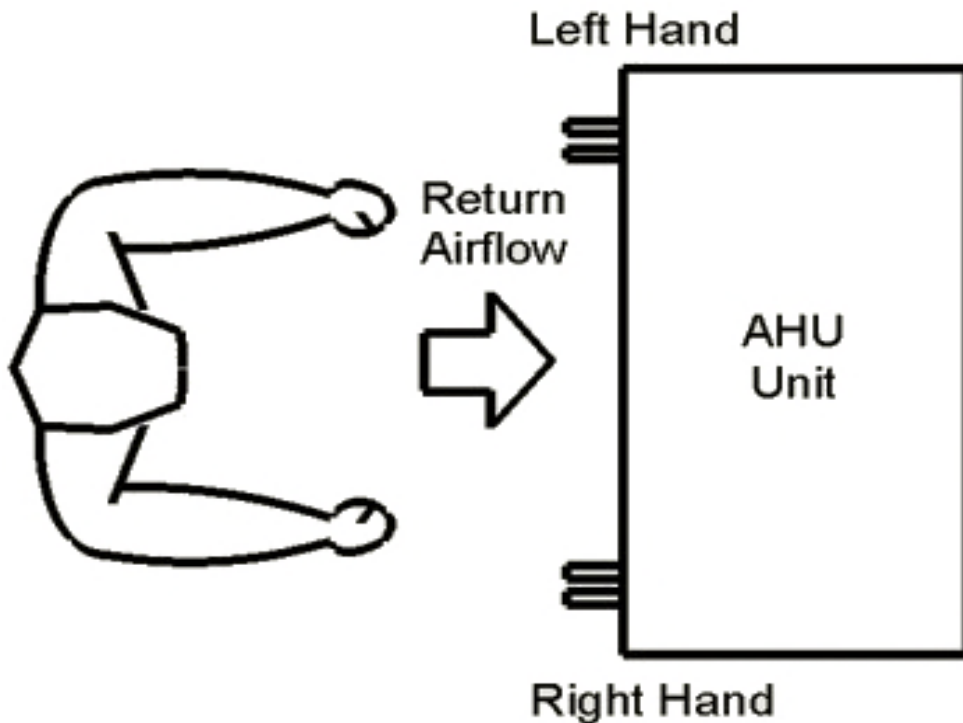

DH to DH-A Units COMMON REPLACEMENT PARTS
DIRECT DRIVE HORIZONTAL AIR HANDLER



DH

Part Number	Description	FITS SERIES	List Price	
373-230043-001	DHW-400 WATER COIL	DH / DHA	600	
373-230042-001	DHW-600 WATER COIL	DH / DHA	635	
373-230041-001	DHW-800 WATER COIL	DH / DHA	675	
373-230040-001	DHW-1000 WATER COIL	DH / DHA	814	
** 758000	400-DH/DHA04/DHB04 HOT WATER COIL ACCESSORY	DH / DHA/ DHB	693	25 days
** 758100	600-DH/DHA06/DHB06 HOT WATER COIL ACCESSORY	DH / DHA/ DHB	716	25 days
** 758200	800-DH/DHA08/DHB08 HOT WATER COIL ACCESSORY	DH / DHA/ DHB	782	25 days
** 758300	1000-DH/DHA10/DHB10 HOT WATER COIL ACCESSORY	DH / DHA/ DHB	838	25 days
373-240016-001	DHX-400 COIL - NO TXV	DH / DHA	700	
373-240017-001	DHX-600 COIL - NO TXV	DH / DHA	641	
373-240018-001	DHX-800 COIL - NO TXV	DH / DHA	786	
373-240012-001	DHX-1000 COIL NO TXV	DH / DHA	808	
373-260841-000	DHX-400 COIL - NO TXV - Phenolic Coated	DH / DHA	1117	15 Days
373-261083-000	DHX-600 COIL - NO TXV - Phenolic Coated	DH / DHA	1158	15 Days
373-240018-101	DHX-800 COIL - NO TXV - Phenolic Coated	DH / DHA	1203	15 Days
373-240012-101	DHX-1000 COIL - NO TXV - Phenolic Coated	DH / DHA	1224	15 Days
076-000225-000	DHW/DHX-400 DRAINPAN	DH / DHA	112	
076-000223-000	DHW/DHX-600 DRAINPAN	DH / DHA	122	
076-000221-000	DHW/DHX-800 DRAINPAN	DH / DHA	132	
076-000219-000	DHW/DHX-1000 DRAINPAN	DH / DHA	188	
102935	DHW/DHX-400 115V MOTOR	DH / DHA	301	SD
102940	DHW/DHX-600 115V MOTOR	DH / DHA	307	SD
102945	DHW/DHX-800 115V MOTOR	DH / DHA	327	SD
102950	DHW/DHX-1000 115V MOTOR	DH / DHA	358	SD
* N/A	DHW/DHX-400 277V MOTOR	DH / DHA		
* N/A	DHW/DHX-600 277V MOTOR	DH / DHA		
* 702964	DHW/DHX-800 277V MOTOR	DH / DHA	626	SD
* N/A	DHW/DHX-1000 277V MOTOR (702966)	DH / DHA	N/A	
* 010-100013-000	DHW/DHX-400 208/230V MOTOR	DH / DHA	397	SD
* 010-100014-000	DHW/DHX-600 208/230V MOTOR	DH / DHA	415	SD
* 010-100015-000	DHW/DHX-800 208/230V MOTOR	DH / DHA	437	SD
102984	DHW/DHX-1000 208/230V MOTOR	DH / DHA	462	SD
702952	MOTOR MOUNT FOR 208/230 & 277 UNITS		62	SD
112028	Capacitor - 5MFD for Motors 102935, 102940, 702962, 010-100014-000, 702964, 702966	DH / DHA	14	SD
010-170019-000	Capacitor - 3MFD for Motors 010-100013-000	DH / DHA	46	SD
112029	Capacitor - 7.5MFD for Motors 102945, 102950	DH / DHA	16	SD
112030	Capacitor - 10MFD for Motors 010-100015-000	DH / DHA	17	SD
106899	Capacitor - 15MFD for Motor 102984	DH / DHA	24	SD
010-120019-001	DH*-400 / DHB04 BLOWER	DH / DHA	166	SD
010-120020-001	DH*-600 / DHB06 BLOWER	DH / DHA	173	SD
010-120020-001	DH*-800 / DHB08 BLOWER	DH / DHA	173	SD
010-120021-001	DH*-1000 / DHB10 BLOWER	DH / DHA	216	SD

* These Motors require the use of a separate motor mount, part number 702952
 ** DH hot water coil accessory has cabinet that mounts on the exterior of the fan coil unit.



DIRECT DRIVE VERTICAL AIR HANDLER

Part Number	Description	FITS SERIES	List Price	
376-000106-000	DVW-400 WATER COIL LH	DV	632	
376-000105-000	DVW-400 WATER COIL RH	DV	632	
376-000112-000	DVW-600 WATER COIL LH	DV	723	
376-000111-000	DVW-600 WATER COIL RH	DV	723	
376-000118-000	DVW-800 WATER COIL LH	DV	838	
376-000117-000	DVW-800 WATER COIL RH	DV	838	
376-000124-000	DVW-1000 WATER COIL LH	DV	980	
376-000123-000	DVW-1000 WATER COIL RH	DV	980	
** 473-270006-001	SIZE 04/06/08 (400/600/800 CFM) HW COIL ACCESSORY - LH	DV/ DVA/ DVB	808	20 Days
** 473-270006-002	SIZE 04/06/08 (400/600/800 CFM) HW COIL ACCESSORY - RH	DV / DVA/ DVB	808	20 Days
** 473-270007-001	SIZE 10 (1000 CFM) HW COIL ACCESSORY - LH	DV / DVA/ DVB	891	20 Days
** 473-270007-002	SIZE 10 (1000 CFM) HW COIL ACCESSORY - RH	DV / DVA/ DVB	891	20 Days
376-000104-001	DVX-400 R22 NO TXV LH	DV	690	
376-000103-001	DVX-400 R22 NO TXV RH	DV	690	
376-000108-001	DVX-600 R22 NO TXV LH	DV	790	
376-000107-001	DVX-600 R22 NO TXV RH	DV	790	
376-000114-001	DVX-800 R22 NO TXV LH	DV	971	
376-000113-001	DVX-800 R22 NO TXV RH	DV	971	
376-000120-001	DVX-1000 R22 NO TXV LH	DV	988	
376-000119-001	DVX-1000 R22 NO TXV RH	DV	988	
376-000104-101	DVX-400 - NO TXV LH - Phenolic Coated	DV	1072	15 Days
376-000103-101	DVX-400 - NO TXV RH - Phenolic Coated	DV	1072	15 Days
375-000108-101	DVX-600 - NO TXV LH - Phenolic Coated	DV	1257	15 Days
TBD	DVX-600 - NO TXV RH - Phenolic Coated	DV		15 Days
376-000114-101	DVX-800 - NO TXV LH - Phenolic Coated	DV	1353	15 Days
TBD	DVX-800 - NO TXV RH - Phenolic Coated	DV		15 Days
376-000120-101	DVX-1000 - NO TXV LH - Phenolic Coated	DV	1370	15 Days
TBD	DVX-1000 - NO TXV RH - Phenolic Coated	DV		15 Days
076-000247-000	DV-400 DRAINPAN	DV	117	
076-000247-000	DV-600 DRAINPAN	DV	117	
076-000247-000	DV-800 DRAINPAN	DV	117	
076-000249-000	DV-1000 DRAINPAN	DV	124	
102935	DV-400 115V MOTOR 1/10HP	DV	301	SD
102940	DV-600 115V MOTOR 1/6HP	DV	307	SD
102945	DV-800 115V MOTOR 1/4HP	DV	327	SD
102950	DV-1000 115V MOTOR 1/3HP	DV	358	SD
* N/A	DV-400 277V MOTOR	DV		
* N/A	DV-600 277V MOTOR	DV		
* 702964	DV-800 277V MOTOR	DV	626	SD
* N/A	DV-1000 277V MOTOR (702966)	DV	N/A	
* 010-100013-000	DV-400 208/230V MOTOR	DV	397	SD
* 010-100014-000	DV-600 208/230V MOTOR	DV	415	SD
* 010-100015-000	DV-800 208/230V MOTOR	DV	437	SD
102984	DV-1000 208/230V MOTOR	DV	462	SD
702952	MOTOR MOUNT FOR 208/230 & 277 UNITS		62	SD
112028	Capacitor - 5MFD for Motors 102935, 102940, 702962, 010-100014-000, 702964, 702966	DH / DHA	14	SD
010-170019-000	Capacitor - 3MFD for Motors 010-100013-000	DH / DHA	46	SD
112029	Capacitor - 7.5MFD for Motors 102945, 102950	DH / DHA	16	SD
112030	Capacitor - 10MFD for Motors 010-100015-000	DH / DHA	17	SD
106899	Capacitor - 15MFD for Motor 102984	DH / DHA	24	SD
010-120019-001	DV-400 BLOWER	DV	166	SD
010-120020-001	DV-600 BLOWER	DV	173	SD
010-120020-001	DV-800 BLOWER	DV	173	SD
010-120021-001	DV-1000 BLOWER	DV	216	SD

* These Motors require the use of a separate motor mount, part number 702952

** Replacement coils listed above are for main DV fan coil unit, except for the 2R Hot Water Accessory

The 2 row DV hot water coil accessory mounts to the exterior of the fan coil unit and includes insulated cabinet (1/2" fiberglass) with polyester powder coating (gray)



BELT DRIVE HORIZONTAL AIR HANDLER

Part Number	Description	FITS SERIES	List Price	
BLOWERS				
* 102995R	BLOWER for 2 ton unit - 024	BH - HBA	475	SD
102999R	BLOWER for 3 ton unit - 036	BH - HBA	510	SD
* 103039R	BLOWER for 4 ton unit - 048	BH - HBA	560	SD
* 103040R	BLOWER for 5 ton unit - 060	BH - HBA	595	SD
* 010-120016-000R	BLOWER for 7.5 ton unit - 090	BH - HBA	698	SD
* 010-120016-000R	BLOWER for 10 ton unit - 120	BH - HBA	698	SD
* 010-120017-001	TWIN BLOWER for 15 ton unit - 180 or 20 ton unit - 240 If air shipment for 010-120017-001 needed, contact factory for quote	BH - HBA	1507	
MOTOR MOUNTS FOR UNITS MANUFACTURED 1993 AND AFTER				
550003	R/P, MOTOR ADJUSTMENT KIT	BH - HBA	45	SD
* 102996	Motor Mount Bracket for 2 ton Unit - 024- fits blower 102995R	BH - HBA	22	SD
* 103001	Motor Mount Bracket for 3 ton Unit - 036- fits blower 102999R	BH - HBA	28	SD
* 103015	Motor Mount Bracket for 4 ton Unit - 048- fits blower 103039R	BH - HBA	22	SD
* HBB20-MTRMNT	Motor Mount Bracket for 5 ton Unit - 060- fits blower 103040R	BH - HBA	107	SD
DRAINPANS				
550078	24-BH DRAINPAN - Galvanized	BH	243	
550072	36-BH DRAINPAN - Galvanized	BH	250	
550285	48-BH DRAINPAN - Galvanized	BH	259	
550385	60-BH DRAINPAN - Galvanized	BH	308	
550485	90-BH DRAINPAN - Galvanized	BH	335	
550585	120-BH DRAINPAN - Galvanized	BH	361	
550685	180-BH DRAINPAN - Galvanized	BH	410	
550785	240-BH DRAINPAN - Galvanized	BH	484	
073-551042-001	24-HBA DRAINPAN - Galvanized	HBA	233	
073-551036-001	36-HBA DRAINPAN - Galvanized	HBA	259	
073-551048-001	48-HBA DRAINPAN - Galvanized	HBA	331	
073-551060-001	60-HBA DRAINPAN - Galvanized	HBA	377	
550443	90-HBA DRAINPAN - Galvanized	HBA	494	
073-251763-001	120-HBA DRAINPAN - Galvanized	HBA	496	
073-250004-000	180-HBA DRAINPAN - Galvanized	HBA	559	
550985	240-HBA DRAINPAN - Galvanized	HBA	948	

* Units manufactured prior to 1993 blowers see page 22. Motor mount brackets installed on blowers prior to 1993. Confirm blower housing dimensions page 22.

Replacement Blowers include blower housing, wheel, shaft, bearings, & bearing brackets



BELT DRIVE HORIZONTAL AIR HANDLER

Part Number	Description	FITS SERIES	List Price
375-000819-001	24-HBH - 2 ROW HOT WATER COIL	BH - HBA	800
375-000802-001	36-HBH - 2 ROW HOT WATER COIL	BH - HBA	845
375-000792-001	48-HBH - 2 ROW HOT WATER COIL	BH - HBA	982
375-000780-001	60-HBH - 2 ROW HOT WATER COIL	BH - HBA	1196
375-260410-000	90-HBH - 2 ROW HOT WATER COIL	BH - HBA	1388
375-261126-001	120-HBH - 2 ROW HOT WATER COIL	BH - HBA	2057
452201	180-HBH - 2 ROW HOT WATER COIL	BH - HBA	2025
464401	240-HBH - 2 ROW HOT WATER COIL	BH - HBA	1562
375-000822-001	24-HBH-1 ROW HOT WATER COIL	BH - HBA	708
375-000805-001	36-HBH-1 ROW HOT WATER COIL	BH - HBA	716
375-000795-001	48-HBH-1 ROW HOT WATER COIL	BH - HBA	848
375-000783-001	60-HBH-1 ROW HOT WATER COIL	BH - HBA	990
375-000816-001	24-BHW-4 - 4ROW CW/HW COIL	BH - HBA	1070
375-000801-001	36-BHW-4 - 4ROW CW/HW COIL	BH - HBA	1128
375-000789-001	48-BHW-4 - 4ROW CW/HW COIL	BH - HBA	1390
375-000776-001	60-BHW-4 - 4ROW CW/HW COIL	BH - HBA	1582
375-260409-000	90-BHW-4 - 4ROW CW/HW COIL	BH - HBA	2087
375-261127-001	120-BHW-4 - 4ROW CW/HW COIL	BH - HBA	1984
375-450601-XXX	180-BHW-4 - 4ROW CW/HW COIL	BH - HBA	2662
375-450701-XXX	240-BHW-4 - 4ROW CW/HW COIL	BH - HBA	2756
375-000813-001	24-BHW-6 - 6ROW CW/HW COIL	BH - HBA	1258
375-000798-001	36-BHW-6 - 6ROW CW/HW COIL	BH - HBA	1384
375-000786-001	48-BHW-6 - 6ROW CW/HW COIL	BH - HBA	1704
375-000773-001	60-BHW-6 - 6ROW CW/HW COIL	BH - HBA	1953
375-260408-000	90-BHW-6 - 6ROW CW/HW COIL	BH - HBA	2101
375-261128-001	120-BHW-6 - 6ROW CW/HW COIL	BH - HBA	3202
375-451401-XXX	180-BHW-6 - 6ROW CW/HW COIL	BH - HBA	2900
375-260371-961	240-BHW-6 - 6ROW CW/HW COIL LH	BH - HBA	3608
375-260371-960	240-BHW-6 - 6ROW CW/HW COIL RH	BH - HBA	3608

NOTE: Replacement coils used in the BH/HBA series will see a difference in stubout locations



BELT DRIVE HORIZONTAL AIR HANDLER

Part Number	Description	FITS SERIES	List Price
R22 Replacement Coils (TXV's included) (single refrigerant circuit unless marked "DUAL")			
375-000633-001	24-BHX/HBAX-3R DX RH R22	BH - HBA	1345
375-000635-001	24-BHX/HBAX-3R DX LH R22	BH - HBA	1340
375-000557-001	36-BHX/HBAX-3R DX RH R22	BH - HBA	1469
375-000556-001	36-BHX/HBAX-3R DX LH R22	BH - HBA	1476
375-000478-001	48-BHX/HBAX-3R DX RH R22	BH - HBA	1590
375-000479-001	48-BHX/HBAX-3R DX LH R22	BH - HBA	1598
375-000373-001	60-BHX/HBAX-3R RH R22	BH - HBA	1772
375-000377-001	60-BHX/HBAX-3R LH R22	BH - HBA	1795
375-261116-001	90-BHX/HBAX-3R RH R22	BH - HBA	2247
375-261117-001	90-BHX/HBAX-3R LH R22	BH - HBA	2097
375-260514-001	120-BHX/HBAX RH R22	BH - HBA	2310
375-260515-001	120-BHX/HBAX LH R22	BH - HBA	2279
375-260535-001	180-BHX/HBAX DUAL RH R22	BH - HBA	2529
375-260536-001	180-BHX/HBAX DUAL LH R22	BH - HBA	2529
375-260537-001	240-BHX/HBAX RH R22 DUAL	BH - HBA	2553
375-260538-001	240-BHX/HBAX LH R22 DUAL	BH - HBA	2596
R410A Replacement Coils (TXV's included) (single refrigerant circuit unless marked "DUAL")			
375-000629-001	24-BHX/HBAX-3R DX RH R410A	BH - HBA	1344
375-000634-001	24-BHX/HBAX-3R DX LH R410A	BH - HBA	1355
375-000528-001	36-BHX/HBAX-3R DX RH R410A	BH - HBA	1486
375-000545-001	36-BHX/HBAX-3R DX LH R410A	BH - HBA	1493
375-000453-001	48-BHX/HBAX-3R DX RH R410A	BH - HBA	1604
375-000455-001	48-BHX/HBAX-3R DX LH R410A	BH - HBA	1611
375-000341-001	60-BHX/HBAX-3R RH R410A	BH - HBA	1788
375-000376-001	60-BHX/HBAX-3R LH R410A	BH - HBA	1786
375-261120-001	90-BHX/HBAX-3R RH R410A	BH - HBA	2002
375-261121-001	90-BHX/HBAX-3R LH R410A	BH - HBA	2014
373-261133-001	120-BHX/HBAX RH R410A	BH - HBA	2652
373-261144-001	120-BHX/HBAX LH R410A	BH - HBA	2657
373-261134-001	120-HBAX RH R410A DUAL	BH - HBA	2795
373-261162-001	120-HBAX LH R410A DUAL	BH - HBA	2767
373-260971-001	180-BHX/HBAX DUAL RH R410A	BH - HBA	2680
373-261042-001	180-BHX/HBAS DUAL LH R410A	BH - HBA	2766
375-261061-001	240-BHX/HBAX RH R410A DUAL	BH - HBA	3015
N/A	240-BHX/HBAX LH R410A DUAL	BH - HBA	#N/A

NOTE: Replacement coils used in the BH/HBA series will see a difference in stubout locations



BELT DRIVE VERTICAL AIR HANDLERS

Part Number	Description	FITS SERIES	List Price	
* 103078	BLOWER for 2/3 ton unit - 024/036	BV thru BV-D	465	SD
* 103039R	BLOWER for 4 ton unit - 048	BV thru BV-D	560	SD
* 103040R	BLOWER for 5 ton unit - 060	BV thru BV-D	595	SD
* 010-120016-000R	BLOWER for 7.5/10 ton unit - 90/120	BV thru BV-D	698	SD

* Units manufactured prior to 1993 blowers see page 22

Blower includes blower housing, wheel, shaft, bearings, & bearing brackets

540485	DRAINPAN 2/3 ton unit - 024/036 - Galvanized	BV thru BV-B	377	
540460	DRAINPAN 2/3 ton unit - 024/036 - Stainless	BV thru BV-B	587	
110-329512-702	DRAINPAN 2/3 ton unit - 024/036 - Polymer	BV-C thru BV-D	153	SD
540685	DRAINPAN for 4 ton unit - 048 - Galvanized	BV thru BV-B	487	
540470	DRAINPAN for 4 ton unit - 048 - Stainless	BV thru BV-B	784	
110-329512-703	DRAINPAN for 4 ton unit - 048 - Polymer - UNAVAILABLE	BV-C thru BV-D	158	
373-270051-000	DRAINPAN for 4 ton unit - 048 - Stainless	BV-C thru BV-D	671	
540885	DRAINPAN for 5 ton unit - 060 - Galvanized	BV thru BV-B	829	
540450	DRAINPAN for 5 ton unit - 060 - Stainless RH	BV thru BV-B	1273	
110-329512-703	DRAINPAN for 5 ton unit - 060 - Polymer - UNAVAILABLE	BV-C thru BV-D	158	
373-270052-000	DRAINPAN for 5 ton unit - 060 - Stainless	BV-C thru BV-D	847	
373-270020-001	DRAINPAN for 7.5 ton unit - 090 - Galvanized	BV thru BV-D	491	
373-270017-000	DRAINPAN for 10 ton unit - 120 - Galvanized	BV thru BV-D	574	
375-250036-001	2 Row Hot Water Coil for 24/36-BV	BV thru BV-D	837	
375-250037-001	2 Row Hot Water Coil for 48-BV	BV thru BV-D	891	
375-250042-001	2 Row Hot Water Coil for 60-BV	BV thru BV-D	963	
444300	2 Row Hot Water Coil for 90-BV	BV thru BV-D	1137	
444400	2 Row Hot Water Coil for 120-BV	BV thru BV-D	1446	

Coils Below Include the Standard Drainpan

376-000529-001	Water - Cooling Coil for 24-BVW	BV thru BV-D	1343	
RP376-000530-001	Water - Cooling Coil for 36-BVW	BV thru BV-D	1589	
376-000531-001	Water - Cooling Coil for 48-BVW - UNAVAILABLE (POLY)	BV thru BV-D	1657	
373-260859-001	Water - Cooling Coil for 48-BVW (SS)	BV thru BV-D	1982	
740800	Water - Cooling Coil for 60-BVW	BV thru BV-B	2153	
376-000532-001	Water - Cooling Coil for 60-BVW-C or D - UNAVAILABLE (POLY)	BV-C thru BV-D	1818	
373-260860-001	Water - Cooling Coil for 60-BVW-C or D (SS)	BV-C thru BV-D	1758	
373-260688-001	Water - Cooling Coil for 90-BVW	BV thru BV-B	2105	
373-260689-001	Water - Cooling Coil for 120-BVW	BV thru BV-B	2169	
TXV's included on these refrigerant coils:				
376-000533-002	DX - R-22 Cooling Coil for 24-BVX	BV thru BV-D	1642	
376-000534-002	DX - R-22 Cooling Coil for 36-BVX	BV thru BV-D	1795	
376-000535-002	DX - R-22 Cooling Coil for 48-BVX - UNAVAILABLE (POLY)	BV thru BV-D	2033	
376-001222-002	DX - R-22 Cooling Coil for 48-BVX (SS)	BV thru BV-D	1833	
742300	DX - R-22 Cooling Coil for 60-BVX	BV thru BV-A	1846	
N/A	DX - R-22 Cooling Coil for 60-BVX	BV-B	#N/A	
376-000536-002	DX - R-22 Cooling Coil for 60-BVX-C or D - UNAVAILABLE (POLY)	BV-C thru BV-D	1805	
376-001223-002	DX - R-22 Cooling Coil for 60-BVX-C or D (SS)	BV-C thru BV-D	2018	
373-260435-001	DX - R-22 Cooling Coil for 90-BVX	BV thru BV-B	2266	
373-260756-001	DX - R-22 Cooling Coil for 90-BVX Dual	BV thru BV-B	2301	
N/A	DX - R-22 Cooling Coil for 120-BVX	BV thru BV-B	#N/A	
373-260436-001	DX - R-22 Cooling Coil for 120-BVX Dual	BV thru BV-B	2538	
376-000533-001	DX - R410A Cooling Coil for 24-BVX	BV thru BV-D	1625	
376-000534-001	DX - R410A Cooling Coil for 36-BVX	BV thru BV-D	1781	
376-000535-001	DX - R410A Cooling Coil for 48-BVX - UNAVAILABLE (POLY)	BV thru BV-D	2038	
376-001222-001	DX - R410A Cooling Coil for 48-BVX (SS)	BV thru BV-D	1834	
N/A	DX - R410A Cooling Coil for 60-BVX	BV thru BV-A	#N/A	
N/A	DX - R410A Cooling Coil for 60-BVX-B	BV-B	#N/A	
376-000536-001	DX - R410A Cooling Coil for 60-BVX-C or D - UNAVAILABLE (POLY)	BV-C thru BV-D	1795	
376-001223-001	DX - R410A Cooling Coil for 60-BVX-C or D (SS)	BV-C thru BV-D	2004	
375-260745-001	DX - R410A Cooling Coil for 90-BVX	BV thru BV-B	2273	
375-260776-001	DX - R410A Cooling Coil for 90-BVX Dual	BV thru BV-B	2538	
N/A	DX - R410A Cooling Coil for 120-BVX	BV thru BV-B	#N/A	
373-260777-001	DX - R410A Cooling Coil for 120-BVX Dual	BV thru BV-B	2596	

* All Coils are Left Hand Connection Only



BELT DRIVE MODULAR AIR HANDLER

Part Number	Description	FITS SERIES	List Price	
103078	BLOWER for 2/3 ton unit - 024/036	BM - BMA	465	SD
103029R	BLOWER for 4/5 ton unit - 048/060	BM - BMA	475	SD
103053	BLOWER for 7.5/10 ton unit - 090/120	BM - BMA	744	SD
010-120017-001	BLOWER for 15/20 ton unit - 180/240	BM - BMA	1507	

Blower includes blower housing, wheel, shaft, bearings, & bearing brackets

073-551036-001	DRAINPAN for 2/3 ton unit - 024/036	BM - BMA	259	
561704	DRAINPAN for 4/5 ton unit - 048/060	BM - BMA	295	
562733	DRAINPAN for 7.5/10 ton unit - 90/120	BM - BMA	380	
563304	DRAINPAN for 15/20 ton unit - 180/240	BM - BMA	445	
375-451601-XXX	2 Row Hot Water Coil for 24-BM	BM - BMA	963	
375-451702-XXX	2 Row Hot Water Coil for 36-BM	BM - BMA	1011	
375-463900-XXX	2 Row Hot Water Coil for 48-BM	BM - BMA	2374	
375-464000-XXX	2 Row Hot Water Coil for 60-BM	BM - BMA	2502	
375-464100-XXX	2 Row Hot Water Coil for 90-BM	BM - BMA	2575	
375-464200-XXX	2 Row Hot Water Coil for 120-BM	BM - BMA	2784	
464300	2 Row Hot Water Coil for 180-BM	BM - BMA	2875	
375-464401-XXX	2 Row Hot Water Coil for 240-BM	BM - BMA	3869	
450001	4 Row CW/HW Coil for 24-BMW	BM - BMA	926	
375-450101-XXX	4 Row CW/HW Coil for 36-BMW	BM - BMA	1250	
461700	4 Row CW/HW Coil for 48-BMW	BM - BMA	1367	
375-462000-XXX	4 Row CW/HW Coil for 60-BMW	BM - BMA	1770	
462500	4 Row CW/HW Coil for 90-BMW	BM - BMA	1976	
462900	4 Row CW/HW Coil for 120-BMW	BM - BMA	2247	
463400	4 Row CW/HW Coil for 180-BMW	BM - BMA	2230	
375-450701-XXX	4 Row CW/HW Coil for 240-BMW	BM - BMA	2756	
450803	6 Row CW/HW Coil for 24-BMW	BM - BMA	1196	
375-450903-XXX	6 Row CW/HW Coil for 36-BMW	BM - BMA	1401	
461800	6 Row CW/HW Coil for 48-BMW	BM - BMA	1759	
375-462100-XXX	6 Row CW/HW Coil for 60-BMW	BM - BMA	1830	
462600	6 Row CW/HW Coil for 90-BMW	BM - BMA	2035	
375-463000-XXX	6 Row CW/HW Coil for 120-BMW	BM - BMA	2467	
463500	6 Row CW/HW Coil for 180-BMW	BM - BMA	3046	
RP451500	6 Row CW/HW Coil for 240-BMW	BM - BMA	2593	
	TXV's included on these refrgerant coils:			
448801	3 Row DX-R22 Cooling Coil for 24-BMX	BM - BMA	1111	
375-448901-XXX	3 Row DX-R22 Cooling Coil for 36-BMX	BM - BMA	1505	
461600	3 Row DX-R22 Cooling Coil for 48-BMX	BM - BMA	1394	
375-461900-XXX	3 Row DX-R22 Cooling Coil for 60-BMX	BM - BMA	1692	
375-462300-XXX	3 Row DX-R22 Cooling Coil 90-BMX	BM - BMA	2025	
375-462700-XXX	3 Row DX-R22 Cooling Coil 120-BMX	BM - BMA	2005	
462800	3 ROW DX-R22 DUAL CIRCT 120-BMX	BM - BMA	2049	
N/A	3 Row DX-R22 Cooling Coil 180-BMX Single	BM - BMA	#N/A	
463300	3 Row DX-R22 Cooling Coil 180-BMX Dual	BM - BMA	2568	
375-260537-001	3 Row DX-R22 Cooling Coil 240-BMX Dual	BM - BMA	2553	
375-260863-001	24-BMX DX RH R410A	BM - BMA	1110	
375-260916-001	24-BMX DX LH R410A	BM - BMA	1140	
375-260452-000	36-BMX DX RH R410A	BM - BMA	1502	
375-260452-000	36-BMX DX LH R410A	BM - BMA	1502	
375-261170-001	48-BMX DX RH R410A	BM - BMA	1532	



BELT DRIVE ROOF TOP AIR HANDLER

Part Number	Description	FITS SERIES	List Price	
103078	BLOWER for 2 ton unit - 024	BR - BR-C	465	SD
103078	BLOWER for 3 ton unit - 036	BR - BR-C	465	SD
103039R	BLOWER for 4 ton unit - 048	BR - BR-C	560	SD
103040R	BLOWER for 5 ton unit - 060	BR - BR-C	595	SD
010-120016-000R	BLOWER for 7.5 ton unit - 090	BR - BR-C	698	SD
010-120016-000R	BLOWER for 10 ton unit - 120	BR - BR-C	698	SD
103053	BLOWER for 15 ton unit - 180	BR - BR-C	744	SD
103056	BLOWER for 20 ton unit - 240	BR - BR-C	1636	SD

Blower includes blower housing, wheel, shaft, bearings, & bearing brackets

076-000214-000	24/36-BR DRAINPAN	BR - BR-C	364	
076-000210-000	48/60-BR DRAINPAN	BR - BR-C	395	
076-000212-000	90/120/180-BR DRAINPAN	BR - BR-C	424	
076-000208-000	240-BR DRAINPAN	BR - BR-C	484	
375-451601-XXX	24-HRH - 2 ROW HOT WATER COIL	BR - BR-C	963	
375-451702-XXX	36-HRH - 2 ROW HOT WATER COIL	BR - BR-C	1011	
451801	48-HRH - 2 ROW HOT WATER COIL	BR - BR-C	1395	
375-451901-XXX	60-HRH - 2 ROW HOT WATER COIL	BR - BR-C	1724	
470400	90-HRH - 2 ROW HOT WATER COIL	BR - BR-C	1837	
470500	120-HRH - 2 ROW HOT WATER COIL	BR - BR-C	2093	
470600	180-HRH - 2 ROW HOT WATER COIL	BR - BR-C	2474	
470650	240-HRH - 2 ROW HOT WATER COIL	BR - BR-C	2577	
450001	24-BRW-4 - 4ROW CW/HW COIL	BR - BR-C	926	
375-450101-XXX	36-BRW-4 - 4ROW CW/HW COIL	BR - BR-C	1250	
450201	48-BRW-4 - 4ROW CW/HW COIL	BR - BR-C	1285	
375-450302-XXX	60-BRW-4 - 4ROW CW/HW COIL	BR - BR-C	1603	
467400	90-BRW-4 - 4ROW CW/HW COIL	BR - BR-C	2073	
467500	120-BRW-4 - 4ROW CW/HW COIL	BR - BR-C	1884	
467600	180-BRW-4 - 4ROW CW/HW COIL	BR - BR-C	2887	
467700	240-BRW-4 - 4ROW CW/HW COIL	BR - BR-C	2576	
450803	24-BRW-6 - 6ROW CW/HW COIL	BR - BR-C	1196	
375-450903-XXX	36-BRW-6 - 6ROW CW/HW COIL	BR - BR-C	1401	
451003	48-BRW-6 - 6ROW CW/HW COIL	BR - BR-C	1529	
375-451103-XXX	60-BRW-6 - 6ROW CW/HW COIL	BR - BR-C	1898	
468200	90-BRW-6 - 6ROW CW/HW COIL	BR - BR-C	2243	
375-468300-XXX	120-BRW-6 - 6ROW CW/HW COIL	BR - BR-C	2560	
468400	180-BRW-6 - 6ROW CW/HW COIL	BR - BR-C	2862	
468500	240-BRW-6 - 6ROW CW/HW COIL	BR - BR-C	3435	



TXV's included on these refrigerant coils:			
Part Number	Description	FITS SERIES	List Price
TBA	24-BRX-3R DX LH R22	BR - BR-C	0
TBA	24-BRX-3R DX RH R22	BR - BR-C	0
375-448901-XXX	36-BRX-3R DX RH R22	BR - BR-C	1505
375-260880-001	36-BRX-3R DX LH R22	BR - BR-C	1391
TBA	48-BRX-3R DX LH R22	BR - BR-C	0
TBA	48-BRX-3R DX RH R22	BR - BR-C	0
375-260870-001	60-BRX-3R LH R22	BR - BR-C	1664
375-449101-XXX	60-BRX-3R RH R22	BR - BR-C	1795
TBA	24-BRX-3R DX RH R410A	BR - BR-C	0
TBA	24-BRX-3R DX LH R410A	BR - BR-C	0
375-260452-000	36-BRX-3R DX RH R410A	BR - BR-C	1502
375-260452-000	36-BRX-3R DX LH R410A	BR - BR-C	1502
TBA	48-BRX-3R DX LH R410A	BR - BR-C	0
TBA	48-BRX-3R DX RH R410A	BR - BR-C	0
375-260477-001	60-BRX-3R RH R410A	BR - BR-C	1683
375-260479-001	60-BRX-3R LH R410A	BR - BR-C	1618
466400	90-BRX-3 - 3R DX-R22 COOLING COIL	BR - BR-C	1845
466600	120-BRX-3 - 3R DX-R22 COOLING COIL	BR - BR-C	2123
466800	180-BRX-3 - 3R DX-R22 COOLING COIL	BR - BR-C	3065
466900	240-BRX-3 - 3R DX-R22 COOLING COIL DUAL	BR - BR-C	3217

DU-B Units COMMON REPLACEMENT PARTS
DIRECT DRIVE UNIVERSAL AIR HANDLER



DU-B

Be sure to add the capacitor below!

Part Number	Description	FITS SERIES	List Price	
010-120020-001	BLOWER for 018/024-DU-A & DU-B	DU-B	173	SD
N/A	BLOWER for 030/036-DU-A & DU-B (103073)	DU-B	N/A	
103076	BLOWER for 042/048-DU-A & DU-B	DU-B	213	SD
103088	BLOWER for 060-DU-A & DU-B	DU-B	304	SD
NOTE: THE FOLLOWING MOTORS REQUIRE A SEPARATE CAPACITOR				
102980	115v MOTOR for 018/024-DU-A & DU-B - 1/4 HP	DU-B	284	SD
102983	115v MOTOR for 030/036-DU-A & DU-B - 1/3 HP	DU-B	300	SD
010-100000-000	115v MOTOR for 042/048-DU-A & DU-B - 3/4 HP	DU-B	420	SD
010-100000-000	115v MOTOR for 060-DU-A & DU-B - 3/4 HP	DU-B	420	SD
102981	208/240v MTR for 018/024-DU-A & DU-B 1/4HP	DU-B	391	SD
102984	208/240v MTR for 030/036-DU-A & DU-B 1/3HP	DU-B	462	SD
102987	208/240v MTR for 042/048-DU-A & DU-B 3/4HP	DU-B	473	SD
102990	208/240v MTR for 060-DU-A & DU-B 1/2HP	DU-B	470	SD
112030	Capacitor for Motor 102980, 102981	DU-B	17	SD
106899	Capacitor for Motor 102983, 102984, 102987	DU-B	24	SD
106860	Capacitor for Motor 010-100000-000, 102990	DU-B	29	SD
373-270007-001	DRAINPAN for 018/024-DU-B	DU-B	473	
584104	DRAINPAN for 030/036-DU-B	DU-B	518	
584204	DRAINPAN for 042/048-DU-B	DU-B	599	
584304	DRAINPAN for 060-DU-B	DU-B	614	
375-484040-XXX	3Row Water Cooling Coil for 024-DUW-B	DU-B	862	
375-484050-XXX	4Row Water Cooling Coil for 024-DUW-B	DU-B	982	
375-484140-XXX	3Row Water Cooling Coil for 036-DUW-B	DU-B	1031	
375-484150-XXX	4Row Water Cooling Coil for 036-DUW-B	DU-B	1110	
375-484240-XXX	3Row Water Cooling Coil for 048-DUW-B	DU-B	1201	
375-484250-XXX	4Row Water Cooling Coil for 048-DUW-B	DU-B	1417	
375-484300-XXX	3Row Water Cooling Coil for 060-DUW-B	DU-B	1468	
375-484310-XXX	4Row Water Cooling Coil for 060-DUW-B	DU-B	1670	
375-260234-002	3Row DX With R22 TXV Mounted 018-DUX-B	DU-B	983	
373-260236-002	3Row DX With R22 TXV Mounted 024-DUX-B	DU-B	862	
373-260238-002	3Row DX With R22 TXV Mounted 030-DUX-B	DU-B	1495	
373-260240-002	3Row DX With R22 TXV Mounted 036-DUX-B	DU-B	1080	
373-260242-002	3Row DX With R22 TXV Mounted 042-DUX-B	DU-B	1315	
373-260244-002	3Row DX With R22 TXV Mounted 048-DUX-B	DU-B	1277	
373-260246-002	3Row DX With R22 TXV Mounted 060-DUX-B	DU-B	1487	
373-260235-001	4Row DX-R22 With TXV for 018-DUX-B	DU-B	1047	
373-260237-001	4Row DX-R22 With TXV for 024-DUX-B	DU-B	1010	
375-260239-001	4Row DX-R22 With TXV for 030-DUX-B	DU-B	1326	
375-260241-001	4Row DX-R22 With TXV for 036-DUX-B	DU-B	1220	
373-260243-001	4Row DX-R22 With TXV for 042-DUX-B	DU-B	1220	
375-260245-001	4Row DX-R22 With TXV for 048-DUX-B	DU-B	1743	
373-260247-001	4Row DX-R22 W/TXV for 060-DUX-B	DU-B	1818	
373-260704-001	4Row DX-R410A With TXV for 018-DUX-B	DU-B	1166	
373-240045-001	4Row DX-R410A With TXV for 024-DUX-B	DU-B	1045	
373-240046-001	4Row DX-R410A With TXV for 036-DUX-B	DU-B	1273	
373-240032-002	4Row DX-R410A With TXV for 048-DUX-B	DU-B	1314	
373-240033-002	4Row DX-R410A With TXV for 060-DUX-B	DU-B	1633	
375-484410-XXX	2Row HW Heating Coil for 018/024-DU-B	DU-B	538	
375-484430-XXX	3Row HW Heating Coil for 018/024-DU-B	DU-B	699	
375-484450-XXX	2Row HW Heating Coil for 030/036-DU-B	DU-B	707	
375-484470-XXX	3Row HW Heating Coil for 030/036-DU-B	DU-B	776	
375-485320-XXX	3Row HW Heating Coil for 042/048-DU-A/B	DU-B	938	
375-485340-XXX	4Row HW Heating Coil for 042/048-DU-A/B	DU-B	1073	
375-485360-XXX	3Row HW Heating Coil for 060-DU-A/B	DU-B	1081	
375-485380-XXX	4Row HW Heating Coil for 060-DU-AB	DU-B	1246	
N/A	Controller, HW/DX/Fan (010-170007-000)	DU-B	N/A	
112003	Transformer - 40VA 120V:24V	DU-B	63	SD
112158	Transformer - 40VA 208-230V:24V	DU-B	97	SD
112000	Fan Relay - 12A/NO-NC/24V	DU-B	94	SD
N/A	Hot Water Pump for DU/KV Series (102165)	DU-B	N/A	
DUB-112038	Motor Mount Kit - 042/048/	DU-B	51	SD
112036	Motor Mount - 060	DU-B	24	SD

*Note: Heating Coils shown are for external mounted pumps, for internal contact factory

CH*/CEW-A Units COMMON REPLACEMENT PARTS
DIRECT DRIVE UNCASSED FAN COIL



**006/012-
CH*/CEW-A**

Part Number	Description	FITS SERIES	List Price	
102963	115V Motor - 1/15 HP	006/012-CH*/CEW-A	306	SD
102955	115V Motor Hi Static - 1/10 HP	006/012-CH*/CEW-A	270	SD
102964	208/230V Motor - 1/15 HP	006/012-CH*/CEW-A	285	SD
102994	208/230V Motor Hi Static - 1/10 HP	006/012-CH*/CEW-A	299	SD
Motors include capacitor				
112021	Blower Wheel - Clock Wise Rotation	006-CH*/CEW-A	48	SD
103090	Blower Wheel - Clock Wise Rotation	012-CH*/CEW-A	89	SD
112021	Blower Wheel - HI Stat CW Rotation	006-CH*/CEW-A	48	SD
112232	Blower Wheel - HI Stat CW Rotation	012-CH*/CEW-A	54	SD
571253	Motor Mounting Bracket	All	30	
112020	Motor Mounting Clip	All	4	SD
010-120024-000	Blower Housing	006-CH*/CEW-A	180	
010-120024-001	Blower Housing	012-CH*/CEW-A	180	
076-000321-000	Drainpan - Galv	006/012-CH*/CEW-A	213	
076-000367-000	Drainpan - Stainless Steel	006/012-CH*/CEW-A	308	
375-220045-012	Return Air Plenum Kit	012-CH*/CEW-A	546	
375-472600-XXX	3Row Water Coil	006-CH*/CEW-A	565	
472602	4Row Water Coil	006-CH*/CEW-A	597	
472604	5Row Water Coil	006-CH*/CEW-A	902	
472606	3Row Chilled Water - 1Row Hot Water	006-CH*/CEW-A	614	
472608	1Row Hot Water - 3Row Chilled Water	006-CH*/CEW-A	614	
472610	4Row Chilled Water - 1Row Hot Water	006-CH*/CEW-A	908	
472612	1Row Hot Water - 4Row Chilled Water	006-CH*/CEW-A	908	
472614	3Row Chilled Water - 2Row Hot Water	006-CH*/CEW-A	908	
472616	2Row Hot Water - 3Row Chilled Water	006-CH*/CEW-A	908	
375-472620-XXX	3Row Water Coil	012-CH*/CEW-A	570	
472622	4Row Water Coil	012-CH*/CEW-A	602	
472624	5Row Water Coil	012-CH*/CEW-A	993	
472626	3Row Chilled Water - 1Row Hot Water	012-CH*/CEW-A	679	
472628	1Row Hot Water - 3Row Chilled Water	012-CH*/CEW-A	679	
472630	4Row Chilled Water - 1Row Hot Water	012-CH*/CEW-A	993	
472632	1Row Hot Water - 4Row Chilled Water	012-CH*/CEW-A	993	
472634	3Row Chilled Water - 2Row Hot Water	012-CH*/CEW-A	993	
472636	2Row Hot Water - 3Row Chilled Water	012-CH*/CEW-A	924	
TBA	DX Coil Less TXV	012-CH*/CEW-A		
472736	1Row Hot Water Coil for DX Units	012-CH*/CEW-A	506	
472746	2Row Hot Water Coil for DX Units	012-CH*/CEW-A	547	
112003	Transformer - 40VA 120:20 QC	ALL	63	SD
112158	Transformer - 40VA 208/240:24 QC	ALL	97	SD
112000	Fan Relay - 12A/NO-NC/24V	ALL	94	SD

CH*/CEW-A Units COMMON REPLACEMENT PARTS



018-CH*/CEW-A

DIRECT DRIVE UNCASSED FAN COIL

Part Number	Description	FITS SERIES	List Price	
102966	115V Motor - 1/10 HP	018-CH*/CEW-A	292	SD
102954	115V Motor Hi Static - 1/8 HP	018-CH*/CEW-A	349	SD
102968	277V Motor - 1/10 HP	018-CH*/CEW-A	324	
102967	208/230V Motor - 1/10 HP	018-CH*/CEW-A	299	SD
102959	208/230V Motor Hi Static - 1/8 HP	018-CH*/CEW-A	320	SD
Motors include capacitor				
103092	Blower Wheel - Clock Wise Rotation	018-CH*/CEW-A	75	SD
103093	Blower Wheel - CCW Rotation	018-CH*/CEW-A	75	SD
112021	Blower Wheel - HI Stat CW Rotation	018-CH*/CEW-A	52	SD
112022	Blower Wheel - HI Stat CCW Rotation	018-CH*/CEW-A	52	SD
571253	Motor Mounting Bracket	All	32	
112020	Motor Mounting Clip	All	4	SD
010-120024-000	Blower Housing	018-CH*/CEW-A	180	
076-000322-000	Drainpan - Galv	018-CH*/CEW-A	224	
076-000368-000	Drainpan - Stainless Steel	018-CH*/CEW-A	341	
173-220045-018	Return Air Plenum Kit	018-CH*/CEW-A	579	
472640	3Row Water Coil	018-CH*/CEW-A	631	
472642	4Row Water Coil	018-CH*/CEW-A	578	
472644	5Row Water Coil	018-CH*/CEW-A	1162	
472646	3Row Chilled Water - 1Row Hot Water	018-CH*/CEW-A	767	
472648	1Row Hot Water - 3Row Chilled Water	018-CH*/CEW-A	767	
472650	4Row Chilled Water - 1Row Hot Water	018-CH*/CEW-A	1275	
472652	1Row Hot Water - 4Row Chilled Water	018-CH*/CEW-A	1275	
472654	3Row Chilled Water - 2Row Hot Water	018-CH*/CEW-A	1275	
472656	2Row Hot Water - 3Row Chilled Water	018-CH*/CEW-A	1275	
472728XR	R22 DX Coil w/TXV	018-CH*-A	903	
373-260715-001	R410A Coil W/TXV	018-CH*-A	903	
472738	1Row Hot Water Coil for DX Units	018-CH*-A	548	
472748	2Row Hot Water Coil for DX Units	018-CH*-A	571	

CH*/CEW-A Units COMMON REPLACEMENT PARTS



**024/030-
CH*/CEW-A**

DIRECT DRIVE UNCASSED FAN COIL

Part Number	Description	FITS SERIES	List Price	
102973	115V Motor - 1/8HP	024/030-CH*/CEW-A	310	SD
102998	115V Motor Hi Static - 1/4 HP	024/030-CH*/CEW-A	353	SD
102974	208/230V Motor - 1/8 HP	024/030-CH*/CEW-A	347	SD
102957	208/230V Motor Hi Static - 1/4 HP	024/030-CH*/CEW-A	334	SD
Motors include capacitor				
103090	Blower Wheel - Clock Wise Rotation	024-CH*/CEW-A	89	SD
103091	Blower Wheel - CCW Rotation	024-CH*/CEW-A	75	SD
012-000033-002	Blower Wheel - Clock Wise Rotation	030-CH*/CEW-A	108	SD
012-000033-001	Blower Wheel - CCW Rotation	030-CH*/CEW-A	108	SD
112232	Blower Wheel - HI Stat CW Rotation	024-CH*/CEW-A	54	SD
112233	Blower Wheel - HI Stat CCW Rotation	024-CH*/CEW-A	54	SD
012-000033-002	Blower Wheel - HI Stat CW Rotation	030-CH*/CEW-A	108	SD
012-000033-001	Blower Wheel - HI Stat CCW Rotation	030-CH*/CEW-A	108	SD
571253	Motor Mounting Bracket	All	30	
112020	Motor Mounting Clip	All	4	SD
010-120024-001	Blower Housing	024-CH*/CEW-A	180	
010-120024-002	Blower Housing	030-CH*/CEW-A	180	
076-000364-000	Drainpan - Galv	024-CH*/CEW-A	235	
076-000323-000	Drainpan - Galv	030-CH*/CEW-A	242	
076-000369-000	Drainpan - Stainless Steel	024-CH*/CEW-A	353	
076-000370-000	Drainpan - Stainless Steel	030-CH*/CEW-A	358	
173-220045-024	CHA08 RETURN AIR PLENUM KIT	024-CH*/CEW-A	660	
472660	3Row Water Coil	024-CH*/CEW-A	626	
472662	4Row Water Coil	024-CH*/CEW-A	701	
472664	5Row Water Coil	024-CH*/CEW-A	1282	
472666	3Row Chilled Water - 1Row Hot Water	024-CH*/CEW-A	723	
472668	1Row Hot Water - 3Row Chilled Water	024-CH*/CEW-A	723	
472670	4Row Chilled Water - 1Row Hot Water	024-CH*/CEW-A	1286	
472672	1Row Hot Water - 4Row Chilled Water	024-CH*/CEW-A	1286	
472674	3Row Chilled Water - 2Row Hot Water	024-CH*/CEW-A	1286	
472676	2Row Hot Water - 3Row Chilled Water	024-CH*/CEW-A	1396	
472730XR	R22 DX Coil w/TXV	024-CH*-A	978	
373-260715-002	R410A Coil W/TXV	024-CH*-A	978	
472740	1Row Hot Water Coil for DX Units	024-CH*/CEW-A	589	
472750	2Row Hot Water Coil for DX Units	024-CH*/CEW-A	602	
472680	3Row Water Coil	030-CH*/CEW-A	786	
472682	4Row Water Coil	030-CH*/CEW-A	862	
472684	5Row Water Coil	030-CH*/CEW-A	1351	
472686	3Row Chilled Water - 1Row Hot Water	030-CH*/CEW-A	878	
472688	1Row Hot Water - 3Row Chilled Water	030-CH*/CEW-A	878	
472690	4Row Chilled Water - 1Row Hot Water	030-CH*/CEW-A	1395	
472692	1Row Hot Water - 4Row Chilled Water	030-CH*/CEW-A	1395	
472694	3Row Chilled Water - 2Row Hot Water	030-CH*/CEW-A	1395	
472696	2Row Hot Water - 3Row Chilled Water	030-CH*/CEW-A	1395	
472732XR	R22 DX Coil w/TXV	030-CH*-A	1165	
373-260717-001	R410A Coil W/TXV	030-CH*-A	973	
472742	1Row Hot Water Coil for DX Units	030-CH*/CEW-A	709	
472752	2Row Hot Water Coil for DX Units	030-CH*/CEW-A	745	

CH*/CEW-A Units COMMON REPLACEMENT PARTS



**036-CH*/
CEW-A**

DIRECT DRIVE UNCASSED FAN COIL

Part Number	Description	FITS SERIES	List Price	
102966	115V Motor - 1/10 HP	036-CH*/CEW-A	292	SD
102954	115V Motor Hi Static - 1/8 HP	036-CH*/CEW-A	323	SD
102967	208/230V Motor - 1/10 HP	036-CH*/CEW-A	299	SD
102959	208/230V Motor Hi Static - 1/8 HP	036-CH*/CEW-A	296	SD
Motors include capacitor				
103092	Blower Wheel - Clock Wise Rotation	036-CH*/CEW-A	75	SD
103093	Blower Wheel - CCW Rotation	036-CH*/CEW-A	75	SD
112021	Blower Wheel - HI Stat CW Rotation	036-CH*/CEW-A	48	SD
112022	Blower Wheel - HI Stat CCW Rotation	036-CH*/CEW-A	48	SD
571253	Motor Mounting Bracket	All	30	
112020	Motor Mounting Clip	All	4	SD
010-120024-000	Blower Housing	036-CH*/CEW-A	180	
076-000234-000	Drainpan - Galv	036-CH*/CEW-A	259	
076-000235-000	Drainpan - Stainless Steel	036-CH*/CEW-A	452	
472700	3Row Water Coil	036-CH*/CEW-A	980	
472702	4Row Water Coil	036-CH*/CEW-A	907	
472704	5Row Water Coil	036-CH*/CEW-A	1450	
472706	3Row Chilled Water - 1Row Hot Water	036-CH*/CEW-A	907	
472708	1Row Hot Water - 3Row Chilled Water	036-CH*/CEW-A	907	
472710	4Row Chilled Water - 1Row Hot Water	036-CH*/CEW-A	1451	
472712	1Row Hot Water - 4Row Chilled Water	036-CH*/CEW-A	1451	
472714	3Row Chilled Water - 2Row Hot Water	036-CH*/CEW-A	1451	
472716	2Row Hot Water - 3Row Chilled Water	036-CH*/CEW-A	1451	
472734XR	R22 DX Coil w/TXV	036-CH*-A	1380	
373-260717-002	R410A Coil W/TXV	036-CH*-A	1380	
472744	1Row Hot Water Coil for DX Units	036-CH*/CEW-A	886	
472754	2Row Hot Water Coil for DX Units	036-CH*/CEW-A	949	



DIRECT DRIVE VERTICAL FAN COIL

Part Number	Description	FITS SERIES	List Price
112234	BLOWER WHEEL - KV Units	018/024/030-KV	216
103050	BLOWER WHEEL - CKV Units	018/024-CKVX	96
112234	BLOWER WHEEL - CKV Units	030-CKVX	216
112174	1/4HP MOTOR - 115V	018/020/030-KV	N/A
102984	1/4HP MOTOR - 208/240V	018/020/030-KV	462
112174	1/4HP MOTOR - 115V	018/024/030-CKV	N/A
102983	1/3HP MOTOR - 115V	018/024/030-KV-A	300
102984	1/3HP MOTOR - 208/240V	018/024/030-KV-A	462
102983	1/3HP MOTOR - 115V	018/024/030-KV-B	300
102984	1/3HP MOTOR - 208/240V	018/024/030-KV-B	462
CONTACT FACTORY FOR AVAILIBLTY OF THE COILS BELOW			
470800	018-KVX L.H. DX Coil no TXV	018-KVX	590
N/A	018-CKVX R.H. DX Coil no TXV (470810)	018-CKVX	N/A
475010	018/024/030-KVX-A-3 DX No TXV	018-KVX-A	584
475018	018-KVX-B-3 DX Coil No TXV	018-KVXB	595
470830	024-KVX L.H. DX Coil no TXV	024-KVX	590
470812	024-CKVX R.H. DX Coil no TXV	024-CKVX	590
475010	018/024/030-KVX-A-3 DX No TXV	024-KVX-A	584
475013	024-KVX-B-3 DX Coil No TXV	024-KVXB	595
470860	030-KVX L.H. DX Coil no TXV	030-KVX	590
N/A	030-CKVX R.H. DX Coil no TXV (470814)	030-CKVX	N/A
475010	018/024/030-KVX-A-3 DX No TXV	030-KVX-A	584
475016	030-KVX-B-3 DX Coil No TXV	030-KVXB	595
N/A	018/024/030-CKVX-2R HW W/PUMP (470885)	018/024/030-CKVX	N/A
N/A	018/024/030-CKVX-3R HW W/PUMP (470880)	018/024/030-CKVX	N/A
N/A	018/024/030-KV-A-2R H.W Coil (475120)	018/024/030-KVX-A	N/A
475100	018/024/030-KV-A-3R H.W Coil	018/024/030-KVX-A	520
HX, HW, VX, VW DRAINPANS			
541785	HX-7.5V/HW-7.5 DRAINPAN ASSY	HX/HW	180
583637	R/P, DRAINPAN HW/HX-10	HX/HW	101
540470	VW/VX-4 SS DRAIN PAN ASSEMBLY	VX/VW	847
540450	VX/VW-5 SS DRAINPAN ONLY	VX/VW	1375
542495	VX/VW-7.5 STAINLESS DRAINPAN	VX/VW	920
373-270017-000	VX-10V DRAIN PAN ASSEMBLY	VX	620
373-270017-001	VW-10B DRAINPAN ASSEMBLY SS	VW	574
541285	VW-10B DRAINPAN ASSEMBLY	VW	311
542885	VX-15V DRAINPAN ASSY	VX	657

SD

SD

SD

SD

SD

Part Number	Description	Motor Code	List Price	
702580	1/4 HP 115-1-60	B1	320	SD
N/A	1/4 HP 115/208/230-1-60 (702585)	B1	N/A	
N/A	1/3 HP 115/208/230-1-60 (702535)	B2	N/A	
702621	1/2 HP 115/208-230-1-60	B3	473	SD
702654	3/4 HP 115/208-230-1-60	B4	532	SD
702675	1 HP 115/208-230-1-60	B5	566	SD
702683	1 1/2 HP 115/208-230-1-60	B6	611	SD
702695	2 HP 115/208-230-1-60	B7	1184	SD
702404	1/2 HP 115/230-1 HIGH EFF	C1	1398	SD
702406	3/4 HP 115/230-1 HIGH EFF	C2	729	SD
702407	1 HP 115/230-1 HIGH EFF	C3	789	SD
N/A	2/SP 1/2 HP 115-1-60 (702589)	E1	N/A	
702106	2/SP 3/4 HP 115-1-60	E2	798	
702107	2/SP 1 HP 115-1-60	E3	962	
N/A	2/SP 1/2 HP 230-1-60 ODP (702634)	F1	N/A	
N/A	2/SP 3/4 HP 208-230-1 (702102)	F2	N/A	
N/A	2/SP 1 HP 208-230-1 (702103)	F3	N/A	
702821	277 1/4 HP 277-1-60	G1	444	
702822	277 1/3 HP 277-1-60	G2	487	SD
702823	277 1/2 HP 277-1-60	G3	489	SD
702824	277 3/4 HP 277-1-60	G4	496	SD
702825	277 1 HP 277-1-60	G5	506	SD
702826	277 1 1/2 HP 277-1-60	G6	995	SD
702827	277 2 HP 277-1-60	G7	1630	SD
N/A	2/SP 1/2 HP 208-230-3 (702212)	K1	N/A	
N/A	2/SP 1/2 HP 460-3 (702216)		N/A	
N/A	2/SP 3/4 HP 208-230-3 (702213)	K2	N/A	
N/A	2/SP 3/4 HP 460-3 (702249)		N/A	
N/A	2/SP 1 HP 208-230-3 (702214)	K3	N/A	
N/A	2/SP 1 HP 460-3 (702250)		N/A	
N/A	2/SP 1 1/2 HP 208-230-3 (702215)	K4	N/A	
N/A	2/SP 1 1/2 HP 460-3 (702253)		N/A	
N/A	2/SP 2 HP 230-3 (702230)	K5	N/A	
N/A	2/SP 2 HP 460-3 (702254)		N/A	
N/A	2/SP 3 HP 460-3 (702255)	K6	N/A	
N/A	2/SP 5 HP 230-3 (702233)	K7	N/A	
N/A	2/SP 5 HP 460-3 (702234)		N/A	
* 012-001063-000	1/2 HP 208-230/460-3 HIGH EFF - 5/8 SHAFT	L1	646	SD
* 012-001057-000	3/4 HP 208-230/460-3 HIGH EFF - 5/8 SHAFT	L2	710	SD
* 010-110008-000	1 HP 208-230/460-3 NEMA PREM - 7/8 SHAFT	L3	1034	SD
* 010-110009-000	1-1/2 HP 208-230/460-3 NEMA PREM - 7/8 SHAFT	L4	1081	SD
* 010-110010-000	2 HP 208-230/460-3 NEMA PREM - 7/8 SHAFT	L5	1146	SD
* 010-110011-000	3 HP 208-230/460-3 NEMA PREM - 1 1/8 SHAFT	L6	1160	SD
* 010-110012-000	5 HP 208-230/460-3 NEMA PREM - 1 1/8 SHAFT	L7	1345	SD
* 010-110013-000	7.5 HP 208-230/460-3 NEMA PREM - 1 3/8 SHAFT	L8	1762	
* 010-110015-000	10 HP 208-230/460-3 NEMA PREM - 1 3/8 SHAFT	L9	1798	
010-110017-000	1/2 HP 575-3 HIGH EFF	N1	646	
N/A	3/4 HP 575-3 HIGH EFF (010-110018-000)	N2	N/A	
010-110019-000	1 HP 575-3 HIGH EFF	N3	1034	
010-110020-000	1-1/2 HP 575-3 HIGH EFF	N4	1081	
010-110021-000	2 HP 575-3 HIGH EFF	N5	1146	
010-110022-000	3 HP 575-3 NEMA PREMIUM	N6	1160	
010-110023-000	5 HP 575-3 NEMA PREMIUM	N7	1345	
010-110024-000	7.5 HP 575-3 NEMA PREMIUM	N8	1933	
010-110025-000	10 HP 575-3 NEMA PREMIUM	N9	2153	

*Note: "L" model replacement motors may have different shaft size than original motor and therefore may require pulley change

STANDARD DRIVES

MOTOR / BLOWER PULLEYS



DRIVES

Part Number	Description	Bore ID	Min PD	Max PD	OD	List Price	
703600	MOTOR SHEAVE 1VL 34 x 1/2	0.5	2.4	3.2	3.15	45	SD
703610	MOTOR SHEAVE 1VL 34 x 5/8	0.625	2.4	3.2	3.15	45	SD
103620	MOTOR SHEAVE 1VL40 X 1/2	0.5	2.7	3.7	3.75	56	SD
103630	MOTOR SHEAVE 1VL40 X 5/8	0.625	2.7	3.7	3.75	56	SD
703640	MOTOR SHEAVE 1VP40 X 7/8	0.875	2.7	3.7	3.75	88	SD
103650	MOTOR SHEAVE 1VL44 X 1/2	0.5	3.1	4.1	4.15	71	SD
103660	MOTOR SHEAVE 1VL44 X 5/8	0.625	3.1	4.1	4.15	71	SD
703661	MOTOR SHEAVE 1VP44 X 7/8	0.875	3.1	4.1	4.15	100	SD
703662	MOTOR SHEAVE 1VP44 X 1 1/8	1.125	3.1	4.1	4.15	107	SD
703661	MOTOR SHEAVE 1VP44 X 7/8	0.875	3.1	4.1	4.15	100	SD
703668	MOTOR SHEAVE 1VP50 X 1 1/8	1.125	3.7	4.7	4.75	120	SD
703665	MOTOR SHEAVE 1VP50 X 1/2	0.5	3.7	4.7	4.75	112	SD
703666	MOTOR SHEAVE 1VP50 X 5/8	0.625	3.7	4.7	4.75	112	SD
703667	MOTOR SHEAVE 1VP50 X 7/8	0.875	3.7	4.7	4.75	120	SD
703683	MOTOR SHEAVE 1VP56 X 1 1/8	1.125	4.3	5.3	5.35	163	SD
703681	MOTOR SHEAVE 1VP56 X 5/8	0.625	4.3	5.3	5.35	125	SD
703682	MOTOR SHEAVE 1VP56 X 7/8	0.875	4.3	5.3	5.35	163	SD
703669	MOTOR SHEAVE 1VP60 X 1 3/8	1.375	3.7	4.7	4.75	155	SD
703686	MOTOR SHEAVE 1VP62 X 1 1/8	1.125	4.5	5.5	5.95	172	SD
703684	MOTOR SHEAVE 1VP62 X 5/8	0.625	4.5	5.5	5.95	172	SD
703685	MOTOR SHEAVE 1VP62 X 7/8	0.875	4.5	5.5	5.95	172	SD
703689	MOTOR SHEAVE 1VP65 X 1 1/8	1.125	4.8	6	6.5	179	SD
703687	MOTOR SHEAVE 1VP65 X 1 3/8	1.375	4.8	6	6.5	179	SD
703688	MOTOR SHEAVE 1VP65 X 7/8	0.875	4.8	6	6.5	179	SD
703692	MOTOR SHEAVE 1VP68 X 1 1/8	1.125	5.1	6.1	6.55	180	SD
703690	MOTOR SHEAVE 1VP68 X 5/8	0.625	5.1	6.1	6.55	180	SD
703691	MOTOR SHEAVE 1VP68 X 7/8	0.875	5.1	6.1	6.55	180	SD
703695	MOTOR SHEAVE 1VP71 X 1 1/8	1.125	5.4	6.6	7.1	189	SD
703693	MOTOR SHEAVE 1VP71 X 1 3/8	1.375	5.4	6.6	7.1	306	SD
703694	MOTOR SHEAVE 1VP71 X 7/8	0.875	5.4	6.6	7.1	189	SD
703698	MOTOR SHEAVE 1VP75 X 1 1/8	1.125	5.8	7	7.5	254	SD
703696	MOTOR SHEAVE 1VP75 X 1 3/8	1.375	5.8	7	7.5	254	SD
703697	MOTOR SHEAVE 1VP75 X 7/8	0.875	5.8	7	7.5	254	SD
NOTE: SHEAVES BELOW REQUIRE HUB AND KEYSTOCK - MATCH EXISTING BORE AND KEYSTOCK SIZE							
103667	BLOWER SHEAVE AK46H				4.45	80	SD
103776	BLOWER SHEAVE AK64H				6.25	89	SD
103777	BLOWER SHEAVE AK84H				8.25	98	SD
103802	BLOWER SHEAVE BK90H				8.75	118	SD
103804	BLOWER SHEAVE BK100H				9.75	132	SD
103805	BLOWER SHEAVE BK110H				10.75	144	SD
103808	BLOWER SHEAVE BK120H				11.75	158	SD
103811	BLOWER SHEAVE BK130H				12.75	174	SD
103832	BLOWER PULLEY HUB H-3/4	0.750				43	SD
103833	BLOWER PULLEY HUB H-1	1.000				43	SD
103840	R/P, KEYSTOCK 3/16X3/16X1 1/4					5	
103850	R/P, KEYSTOCK 1/4 X 1/4 X 1 1/4					7	

Be sure to add the HUB and KEYSTOCK Below!

ID = inside diameter
 PD = pitch diameter
 OD = outside diameter

1. Pitch diameters are used in calculation of RPM at fan shaft
2. Outside diameter is measured at the outside of the pulley and is used to identify which pulley is installed.
3. Bore ID: Note that motor shaft and fan shaft sizes differ so be sure to select the pulley with correct shaft hole diameter.

708321	TOUCH UP PAINT - GRAY	12 OZ SPRAY CAN	39	SD
708321-PEN	TOUCH UP PAINT - GRAY	Paint Pen	39	SD
708316	TOUCH UP PAINT - POLAR ICE	12 OZ SPRAY CAN	39	SD
708316-PEN	TOUCH UP PAINT - POLAR ICE	Paint Pen	39	SD
708310	TOUCH UP PAINT - BEIGE	12 OZ SPRAY CAN	39	SD
708310-PEN	TOUCH UP PAINT - BEIGE	Paint Pen	39	SD

Part Number	Description	FITS SERIES	List Price	
RP101887	24.75 X 10.75 X 1 TA (BOX OF 12)	DH	406	SD
RP101889	20.75 X 12.75 X 1 TA (BOX OF 12)	DH	406	SD
RP101891	27 X 12.75 X 1 TA (BOX OF 12)	DH	409	SD
RP101893	33.75 X 12.75 X 1 TA (BOX OF 12)	DH	452	SD
RP101726	8 X 19 1/4 X 1 TA (BOX OF 12)	DV	371	SD
RP101547	12 X 20 X 1 TA (BOX OF 12)	DV	367	SD
RP101750	16 X 20 X 1 STD T/A (BOX OF 12)	DV	143	SD
RP101549	16 X 25 X 1 TA (BOX OF 12)	DV	143	SD
RP101757	10 X 15 X 1 THROW AWAY (BOX OF 12)	CH	353	SD
RP101758	10 X 18 X 1 THROW AWAY (BOX OF 12)	CH	353	SD
RP101759	10 X 27 X 1 THROW AWAY (BOX OF 12)	CH	386	SD
RP101760	10 X 36 X 1 THROW AWAY (BOX OF 12)	CH	409	SD
RP101761	10 X 45 X 1 THROW AWAY (BOX OF 12)	CH	483	SD
RP101762	10 X 54 X 1 THROW AWAY (BOX OF 12)	CH	512	SD
RP101701	8 5/8X21 5/8X1 TA EXCT (BOX OF 12)	FFW	371	SD
RP101703	8 5/8X25 5/8X1 TA EXCT (BOX OF 12)	FFW	323	SD
RP101744	8 5/8X31 5/8X1 TA EXCT (BOX OF 12)	FFW	358	SD
RP101746	8 5/8X43 5/8X1 TA EXCT (BOX OF 12)	FFW	405	SD
RP101747	8 5/8X57 5/8X1 TA EXCT (BOX OF 12)	FFW	483	SD
RP101748	8 5/8X65 5/8X1 TA EXCT (BOX OF 12)	FFW	395	SD
RP101750	16 X 20 X 1 STD T/A (BOX OF 12)	DU	143	SD
RP101752	18 X 24 X 1 STD T/A (BOX OF 12)	DU	197	SD
RP101754	20 X 25 X 1 STD T/A (BOX OF 12)	DU	133	SD
RP101756	30 X 20 X 1 STD T/A (BOX OF 12)	DU	212	SD
RP101898	10 X 10 X 2 THROW AWAY (BOX OF 12)	VARIOUS	183	SD
RP011-800002-000	12 X 20 X 2 T/A (BOX OF 12)	VARIOUS	275	SD
RP011-800001-000	12 X 25 X 2 T/A (BOX OF 12)	VARIOUS	436	SD
RP101880	16 X 20 X 2 T/A (BOX OF 12)	VARIOUS	178	SD
RP101882	16 X 25 X 2 T/A (BOX OF 12)	VARIOUS	184	SD
RP101888	16 X 32 X 2 T/A (BOX OF 12)	VARIOUS	505	SD
RP101884	20 X 20 X 2 T/A (BOX OF 12)	VARIOUS	184	SD
RP101886	20 X 25 X 2 T/A (BOX OF 12)	VARIOUS	213	SD
RP101894	20 X 32 X 2 T/A (BOX OF 12)	VARIOUS	548	SD
RP101890	22.5 X 22.5 X 2 TA (BOX OF 12)	VARIOUS	505	SD
RP101885	22.5 X 25 X 2 TA (BOX OF 12)	VARIOUS	475	SD
RP101897	24 X 36 X 2 T/A (BOX OF 12)	VARIOUS	472	SD
RP101881	25 X 25 X 2 TA (BOX OF 12)	VARIOUS	182	SD
RP101763	30 X 36 X 2 TA (BOX OF 12)	VARIOUS	386	SD
RP011-800002-002	10 X 10 X 2 PLEATED (BOX OF 12)	VARIOUS	323	SD
RP011-800002-001	12 X 20 X 2 PLEATED (BOX OF 12)	VARIOUS	222	SD
RP011-800001-001	12 X 25 X 2 PLEATED (BOX OF 12)	VARIOUS	406	SD
RP701766	12 X 24 X 2 PLEATED (BOX OF 12)	VARIOUS	239	SD
RP010-090001-000	14 X 20 X 2 PLEATED (BOX OF 12)	VARIOUS	265	SD
RP701743	16 X 20 X 2 PLEATED (BOX OF 12)	VARIOUS	221	SD
RP701745	16 X 25 X 2 PLEATED (BOX OF 12)	VARIOUS	293	SD
RP701750	16 X 32 X 2 PLEATED (BOX OF 12)	VARIOUS	560	SD
RP701755	20 X 20 X 2 PLEATED (BOX OF 12)	VARIOUS	298	SD
RP010-090002-000	20 X 24 X 2 PLEATED (BOX OF 12)	VARIOUS	349	SD
RP701760	20 X 25 X 2 PLEATED (BOX OF 12)	VARIOUS	339	SD
RP010-090003-000	20 X 30 X 2 PLEATED (BOX OF 12)	VARIOUS	533	SD
RP701761	20 X 32 X 2 PLEATED (BOX OF 12)	VARIOUS	602	SD
RP701765	22.5 X 22.5 X 2 PLEATED (BOX OF 12)	VARIOUS	560	SD
RP701762	25X25X2 PLEATED (BOX OF 12)	VARIOUS	259	SD

COMMON THERMAL EXPANSION VALVES



TXV's

R22	Part Number	Fits Models*	Description	List Price	
	012-000035-001	DHB04,DVA04/CHA04	1 Ton R22	218	
	012-000028-001	24-BHX, 24-HBAX, HBB08 24-BVX, 24-BVX-B, 24-BVX-D, BVE08 VX-2V, VX-2-D, VXEA08, VXEB08 24-BMX, BMB08, 24-BRX, BRD08	IVE-2 - R22	104	SD
	012-000029-001	36-BHX, 36-HBAX, HBB12 36-BVX, 36-BVX-B, 36-BVX-D, BVE12 VX-3V, VX-3-D, VXEA12, VXEB12 36-BMX, BMB12, 36-BRX, BRD12	IVE-3 - R22	104	SD
	012-000032-001	48-BHX, 48-HBAX, HBB16 48-BVX, 48-BVX-B, 48-BVX-D, BVE16 VX-4V, VX-4-D, VXEA16, VXEB16 48-BMX, BMB16, 48-BRX, BRD16	IVE-4 - R22	104	SD
	012-000031-001	60-BHX, 60-HBAX, HBB20 60-BVX, 60-BVX-B, 60-BVX-D, BVE20 VX-5V, VX-5-D, VXEA20, VXEB20 60-BMX, BMB20, 60-BRX, BRD20	CBBIVE-5	104	SD
	100740	90-BHX, 90-HBAX, HBB30 90-BVX, 90-BVX-B, BVE30 VX-7.5, VXEA30, VXEB30, HX-7.5 90-BMX, BMB30, 90-BRX, BRD30 HBB60 (2 Req'd), BRD60 (2 Req'd)	SVE-8 - R22	191	SD
	100747	120-BHX, 120-HBAX, HBB40 120-BVX, 120-BVX-B, BVE30 VX-10V, VXEA40, VXEB40, HX-10 120-BMX, BMB40, 120-BRX, BRD40 240-BMX (2 Req'd), BMB80 (2 Req'd)	SVE-10 - R22	207	SD
	012-00271-001	180-BHX, 180-HBAX, VX-15 180-BMX, 180-BRX	PVE-16 - R22	248	SD
	RP010-070025-002	018-DUX-A, 018-DUX-B 024-DUX-A, 024-DUX-B 030-DUX-A, 030-DUX-B DHB06,DHB08,DVA06,DVA08	CBBIVE-2 - R22	94	SD
	RP100832	036-DUX-A, 036-DUX-B 042-DUX-A, 042-DUX-B	Y1132-CBBIVE-3 - R22	177	SD
	N/A	048-DUX-A, 048-DUX-B (RP100833)	Y1132-CBBIVE-4 R22	N/A	
	100835	060-DUX-A, 060-DUX-B	Y1132-CBBIVE-5 R22	178	SD
	RP010-070025-003	DHB10, DVA10	CBBIVE-3-GA	94	SD

R410A	Part Number	Fits Models*	Description	Connection Style	List Price	
	010-070003-002	HBB08, BVE08, BRD08, BMB08	CBBIZE-2 - R410A	SWEAT	168	SD
	010-070003-003	HBB12, BVE12, BRD12, BMB12	CBBIZE-3 - R410A	SWEAT	164	SD
	010-070003-004	HBB16, BVE16, BRD16, BMB16	CBBIZE-4 - R410A	SWEAT	164	SD
	010-070003-005	HBB20, BVE20, BRD20, BMB20	CBBIZE-5 - R410A	SWEAT	222	SD
	010-070022-000	HBB30, BVE30, BRD30, BMB30	BBIZE-8 - R410A	SWEAT	196	SD
	010-070032-000	HBB40, BVE40, BRD40, BMB40	BBIZE-12.5 - R410A	SWEAT	286	SD
	012-000034-001	DHB04,DVA04/CHA04	CBBIZE-1 - R410A	SWEAT	94	
	RP010-070023-002	DHB06, DHB08, DVA06, DVA08	CBBIZE-2 - R410A	CHATLEFF	98	SD
	RP010-070023-003	DHB10, DVA10	CBBIZE-3 - R410A	CHATLEFF	98	SD
	RP010-070023-004	DUC16	CBBIZE-4 - R410A	CHATLEFF	99	SD

Notes:

FOR USE IN STANDARD CAPACITY SINGLE CIRCUIT COILS

FOR DUC VALVES PLEASE REFER TO THE UNIT PRICE PAGES OR NEWMAGIC4 SOFTWARE

R410A TXV's - Note connection style is either sweat or Chatleff threaded pattern for use with threaded "accurater" distributors.

For Changing older coils from R22 to R410A by just changing out TXV's the following rules apply:

If coil is used for Cooling only then changing out the TXV is acceptable for unit size 40 (10 ton) or smaller

If coil is used in heap pump application then changing out TXV is acceptable provided that;

a: Coil was manufactured after October of 2008

b: Unit is size 40 (10 ton) or smaller

Heat Pump Capability: TXV's with "C" Prefix have internal check valve and bypass and are heat pump compatible with no need for heat pump kit (HPK). All others require HPK for heat pump service. Refer to Accessories Price Sheet or NewMagic4 software.

BELT DRIVE REPLACEMENT BLOWER

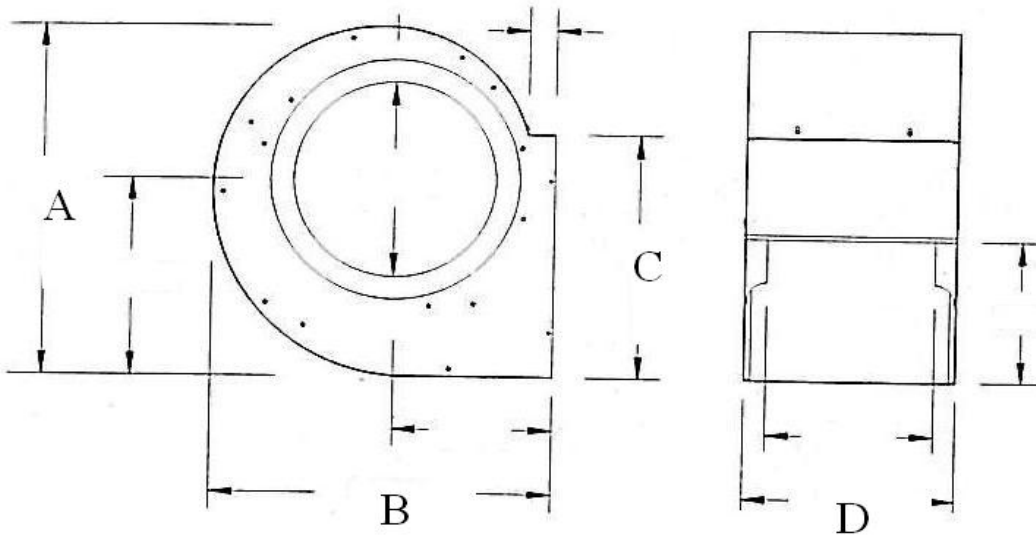

Housing Dimensions (in)

Part Number	Part Description	A	B	C	D	Wheel Dia	Wheel Width	List Price	
010-120003-000*	BLOWER 90-6T BD 0.75 X 14.62	12.5	12.75	10.25	8.25	9	6	471	SD
102995R*	R/P, 90-6R BD .75 BLOWER ASSY	15.68	15.18	10.25	8.25	9	6	475	SD
102999R*	R/P, BLOWER ASSY 90-9R BD #05-	15.68	15.18	10.25	11.81	9	9	510	SD
103078*	R/P, 100-6R BD 0.75	17.43	16.75	11.37	8.25	10	6	465	SD
103029R*	R/P, A10-10 COMPLETE BLOWER	17.43	16.75	11.37	13.12	10	10	475	SD
103039R*	R/P, 120-6R BD .75 BLWR ASSY	20.5	19.37	13.5	8.81	12	6	560	SD
103040R*	R/P, 120-9R COMPLETE BLOWER	20.5	19.37	13.5	12.25	12	9	595	SD
103052*	R/P, 120-12R BD BLOWER ASSY	20.5	19.37	13.5	15.62	12	12	641	SD
010-120016-000R**	R/P, 150-9R BLOWER ASSY	24.25	22.68	15.87	12.81	15	9	698	SD
010-120017-001**	R/P, BLOWER 150-12R TWIN	24.25	22.68	15.87	16.12	15	12	1507	
103053**	R/P, A15-15 COMPLETE BLOWER	24.25	22.68	15.87	18.62	15	15	744	SD
103056**	R/P, G18-18 COMPLETE BLOWER	29	27	18.87	21.87	18.5	18.5	1636	

THESE ARE FOR BELT DRIVE BLOWERS ONLY.

REPLACEMENT PART WILL INCLUDE - WHEEL, HOUSING, SHAFT, BEARINGS, BEARING BRACKET, AND BLOCKOFF

* Fan Shaft OD is 3/4"

** Fan Shaft OD is 1"

Part Number	Description	List Price	
103304	BELT 4L330	12	SD
103305	BELT 4L340	12	SD
103306	BELT 4L350	13	SD
103307	BELT 4L360	13	SD
703307	BELT 4L370	13	SD
103308	BELT 4L380	11	SD
703310	BELT 4L390	13	SD
103320	BELT 4L400	11	SD
103330	BELT 4L410	14	SD
703340	BELT 4L420	14	SD
703345	BELT 4L430	14	SD
703350	BELT 4L440	14	SD
703360	BELT 4L450	14	SD
103370	BELT 4L460	15	SD
703380	BELT 4L470	14	SD
103381	BELT 4L480	14	SD
703385	BELT 4L490	14	SD
703400	BELT 4L500	15	SD
703401	BELT 4L510	15	SD
703410	BELT 4L520	15	SD
703523	BELT B-46	31	SD
703526	BELT B-49	32	SD
703527	BELT B-50	32	SD
703528	BELT B-51	34	SD
703529	BELT B-52	20	SD
703530	BELT B-53	21	SD
703531	BELT B-54	21	SD
703532	BELT B-55	21	SD
703533	BELT B-56	21	SD
703534	BELT B-57	24	SD
703535	BELT B-58	21	SD
703536	BELT B-59	25	SD
703537	BELT B-60	25	SD
703538	BELT B-61	25	SD
703539	BELT B-62	25	SD
703540	BELT B-63	27	SD
703541	BELT B-64	27	SD
703542	BELT B-65	27	SD
703543	BELT B-66	27	SD
703544	BELT B-67	28	SD
703545	BELT B-68	28	SD
703546	BELT B-69	28	SD
703547	BELT B-70	28	SD
703552	BELT B-71	44	SD
703553	BELT B-72	49	SD

Belt Drive Units sold prior to 2021 had either Lovato or GE Starters/Contactors/Overloads. Lovato parts are listed below.

The GE Starters and Contactors previously used are no longer available. They have been obsoleted by the manufacturer. Please follow the following steps for converting to the Lovato equivalent.

Regardless of which starter is currently installed in the unit, refer to the nameplate on the existing motor to confirm the voltage and amperage. The motor may have been replaced. Verify before replacing electrical components.

1) Does the field motor have automatic thermal overloads (ATC)?

If No, a starter and overload relay is needed.

If Yes, a relay or contactor can be used.

2) What is the motor horsepower?

3) What is the motor voltage (in use) and the Full Load Amps (FLA) rating?

Refer to **existing** motor nameplate to determine voltage and FLA. To the right is an example of a nameplate where the motor can be operated at three different voltages. The motor has 230/460 and FLA is 1.72/.861. This means if the motor is operating at 230, it will draw 1.72A. At 460V, it will draw .861A, and at 208V it will draw 1.9A. The nameplate has at the bottom an internal wire diagram that shows how it would be wired internally for a given voltage (one way for 208V and 230V, another way for 460V).



4) Select the contactor from the table below that is sufficient for the motor HP and voltage.

5) If an overload relay is needed, select one where the FLA is within the range of the

**Starter/Overload for Belt Drive AHU with
Motor Start/Stop Station (MSS)**



Starter

Examples:

3 HP, 115V, 32A, no ATC

Select 012-001585-000 contactor as it is the only one rated for 3 HP at 115V(120V).

Select 012-001588-000 overload relay as it is the only one rated to 32A

7.5HP,480V, 9.7 A, no ATC

Any of the contactors will work, I'd use the less costly 012-001583-000,

Select starter 012-001588-000.

STARTER / CONTACTOR		
Voltage/Phase	Maximum HP	Starter PN:
120V/1	Up to 2 HP	012-001583-000
	Up to 3 HP	012-001585-000
240V/1	Up to 3 HP	012-001583-000
	Up to 5 HP	012-001584-000
	Up to 7.5 HP	012-001585-000
200V/3	Up to 5 HP	012-001583-000
	Up to 7.5 HP	012-001584-000
	Up to 10 HP	012-001585-000
240V/3	Up to 5 HP	012-001583-000
	Up to 7.5 HP	012-001584-000
	Up to 10 HP	012-001585-000
480V/3	Up to 10 HP	012-001583-000
	Up to 15 HP	012-001584-000
	Up to 30 HP	012-001585-000
600V/3	Up to 15 HP	012-001583-000
	Up to 20 HP	012-001584-000
	Up to 30 HP	012-001585-000

STARTER / CONTACTOR		
Part Number	Description	List Price
012-001583-000	R/P, CONT 25A/3P/24V DPBF1210A	107
012-001584-000	CONTACTOR 30A/3P/24V DPBF1810A	130
012-001585-000	CONTACTOR 40A/3P/24V DPBF2600A	229

OVERLOAD			
Part Number	Description	RANGE	List Price
012-001586-000	OVERLOAD 0.4-2A RFE450200	.4-2.0A	226
012-001587-000	R/P, OVERLOAD 1.6-8A	1.6-8.0A	226
012-001588-000	OVERLOAD 6.4-32A RFE45320	6.4-32.0A	226

To obtain replacement part numbers and pricing for these models please visit our RPL system on www.magicaire.com

From our homepage - select the box order status/Replacement Parts, then select the link "Replacement Parts" under the DP Products Replacement Parts. You will not need a log in to access the parts side.

From there enter either the unit serial number or full model number in the box shown

After entering on of those two items you will be able to get a specific parts list for that model.

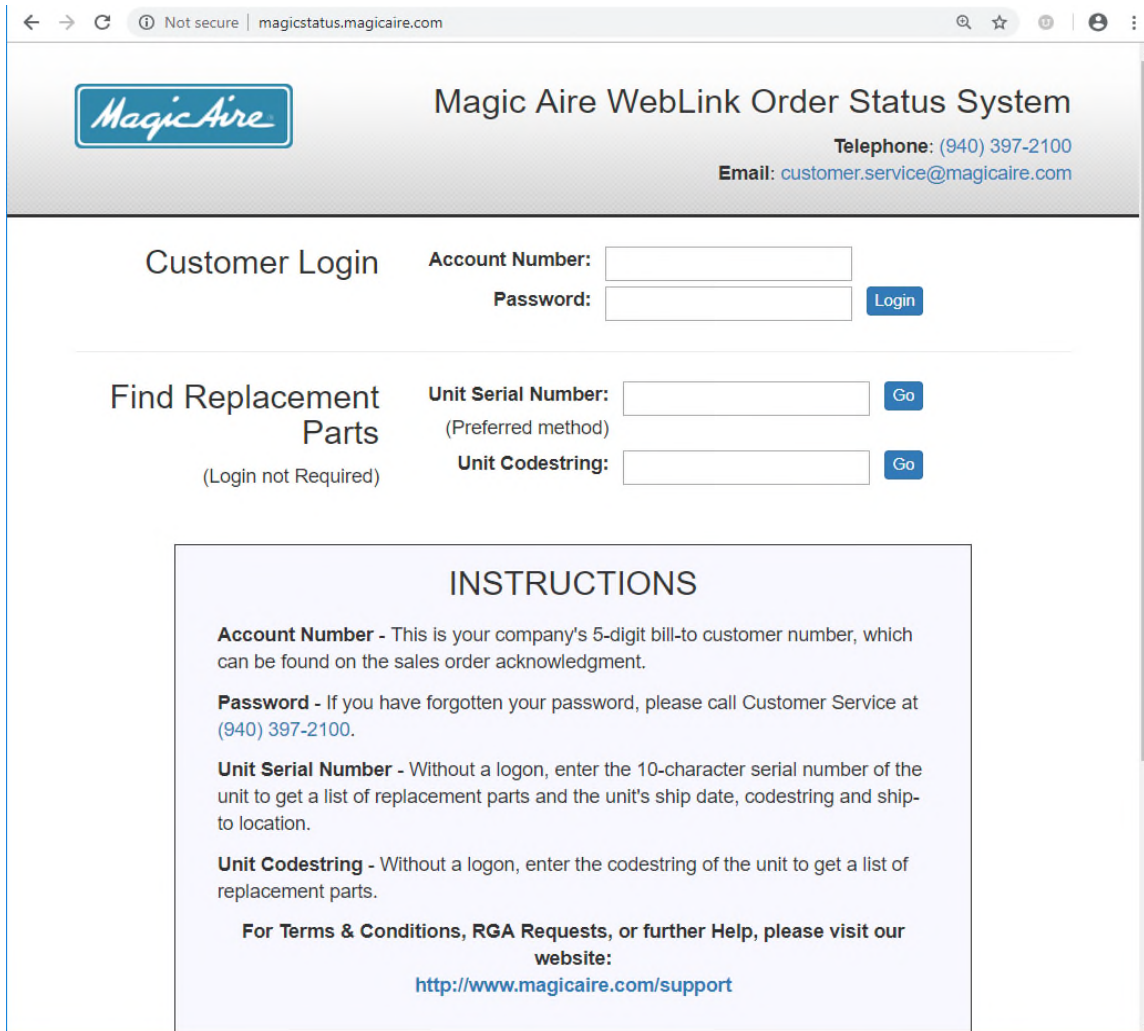

The screenshot shows a web browser window with the URL magicstatus.magicaire.com. The page title is "Magic Aire WebLink Order Status System". The Magic Aire logo is in the top left. Contact information is in the top right: Telephone: (940) 397-2100, Email: customer.service@magicaire.com.

The main content area has two sections:

- Customer Login**: Includes input fields for "Account Number:" and "Password:", and a "Login" button.
- Find Replacement Parts**: Includes input fields for "Unit Serial Number:" (with "(Preferred method)" below it) and "Unit Codestring:", each with a "Go" button. A note "(Login not Required)" is positioned below the "Find Replacement Parts" heading.

Below these sections is a box titled "INSTRUCTIONS" with the following text:

Account Number - This is your company's 5-digit bill-to customer number, which can be found on the sales order acknowledgment.

Password - If you have forgotten your password, please call Customer Service at (940) 397-2100.

Unit Serial Number - Without a logon, enter the 10-character serial number of the unit to get a list of replacement parts and the unit's ship date, codestring and ship-to location.

Unit Codestring - Without a logon, enter the codestring of the unit to get a list of replacement parts.

For Terms & Conditions, RGA Requests, or further Help, please visit our website:
<http://www.magicaire.com/support>

FREIGHT COST ADDERS

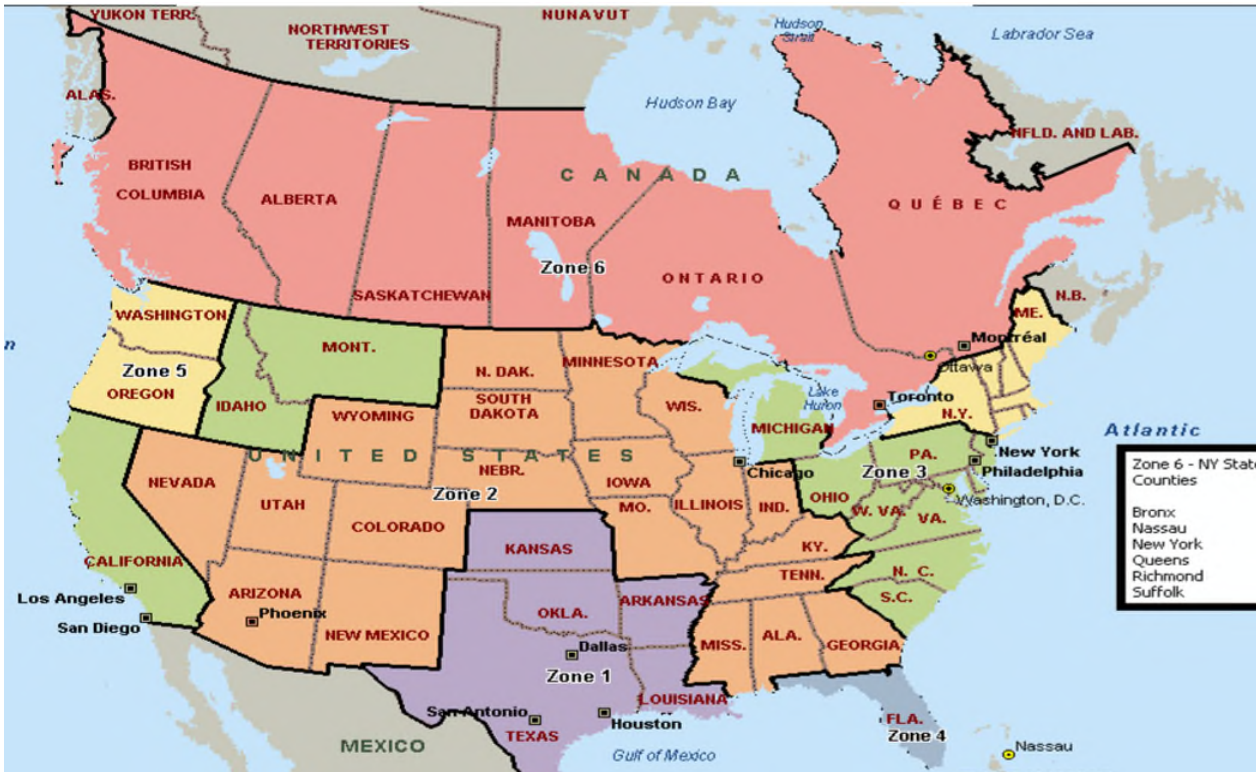

Standard Delivery	Zone 1: Add 3.0% of List Price	Zone 4: Add 4.6% of List Price
	Zone 2: Add 4.2% of List Price	Zone 5: Add 5.5% of List Price
	Zone 3: Add 4.5% of List Price	Zone 6: Add 9.0% of List Price

Zone 6 -- Canada Minimum freight charge of \$125

Expedited Shipping

2-Day Expedite	Zone 1: Add 8.5% of List Price	Zone 3: Add 11% of List Price
	Zone 2: Add 10% of List Price	Zone 4: Add 12% of List Price
3-Day Expedite	Zone 5: Add 12% of List Price	Zone 6: Add 14% of List Price

Unless Expedited shipment is noted on the purchase order, replacement parts will ship Ground.

NON-SUPPORTED MODELS

Non-Supported Models
CCX
CHX
DHW-18/24
DHX-18/24
DVW-18/24
DUP (prior to Rev. B except those listed on p.11)
DUX (prior to Rev. B except those listed on p.11)
DVX-18/24
FHY
HHW
HWBC
HX
KV (except those listed on p.20)
MAHBC
MAVBC
VHW
VW
VWAH
VWBC
VXAH



BELT DRIVE - HORIZONTAL AIR HANDLER

Current	Previous
HBB	HBAW, HBAX, BHW, BHX, HWBC, MAHBC

BELT DRIVE - VERTICAL AIR HANDLER

Current	Previous
BVE	BVW-D, BVX-D, BVW-B, BVX-B, BVW-A, BVX-A, VWBC, MAVBC

BELT DRIVE - MODULAR AIR HANDLER

Current	Previous
BMB	BMW-A, BMX-A, BMW, BMX, VWAH, VXA

DIRECT DRIVE - HORIZONTAL FAN COIL

Current	Previous
CHA	CHX-A, CEW-A, CHX, CHP
DHB	DHW-A, DHX-A, DHW, DHX, DHW-18/24
N/A	CCX

DIRECT DRIVE - VERTICAL FAN COIL

Current	Previous
DVB	DVA, DVW, DVX
N/A	KVX, KVP

DIRECT DRIVE - UNIVERSAL FAN COIL

Current	Previous
DUC	DUX-B, DUW-B, DUW-A, DUX-A, DUW, DUX, DUP-B, DUP-A, DUP

DUCT COIL - HORIZONTAL

Current	Previous
HWB, HXB	HW, HX

DUCT COIL - VERTICAL

Current	Previous
VWF, VXF	VW, VX

Current Unit Size	Nominal CFM	Nominal Tons	Old Size Designation
02	200	0.5	006
04	400	1	012
06	600	1.5	018
08	800	2	024
10	1000	2.5	30
12	1200	3	036
16	1600	4	048
20	2000	5	060
30	3000	7.5	090
40	4000	10	120
60	6000	15	180
80	8000	20	240