

LEFT SIDE VIEW

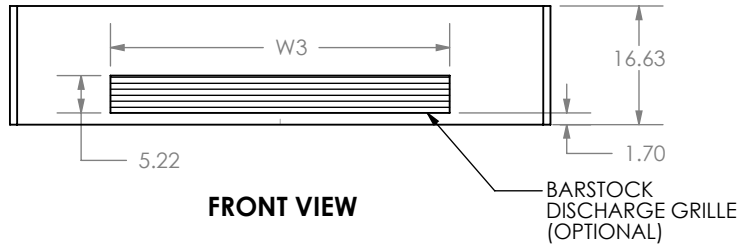

FRONT VIEW

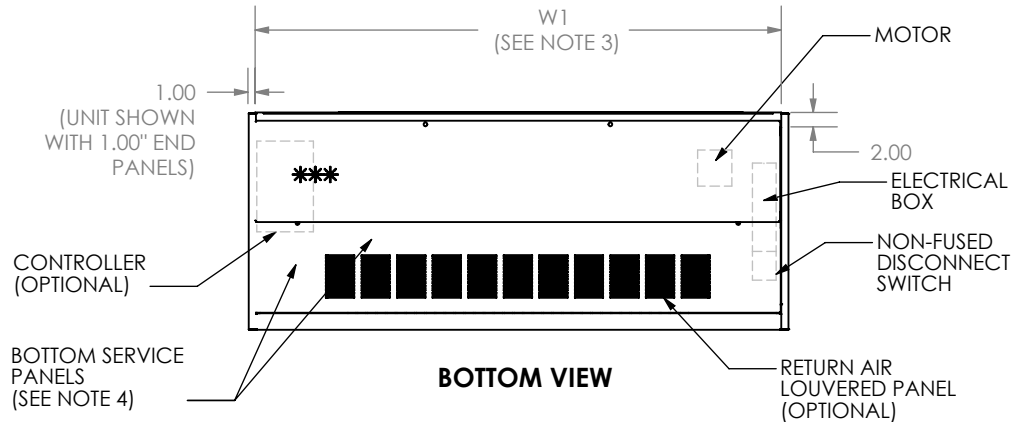

BOTTOM VIEW

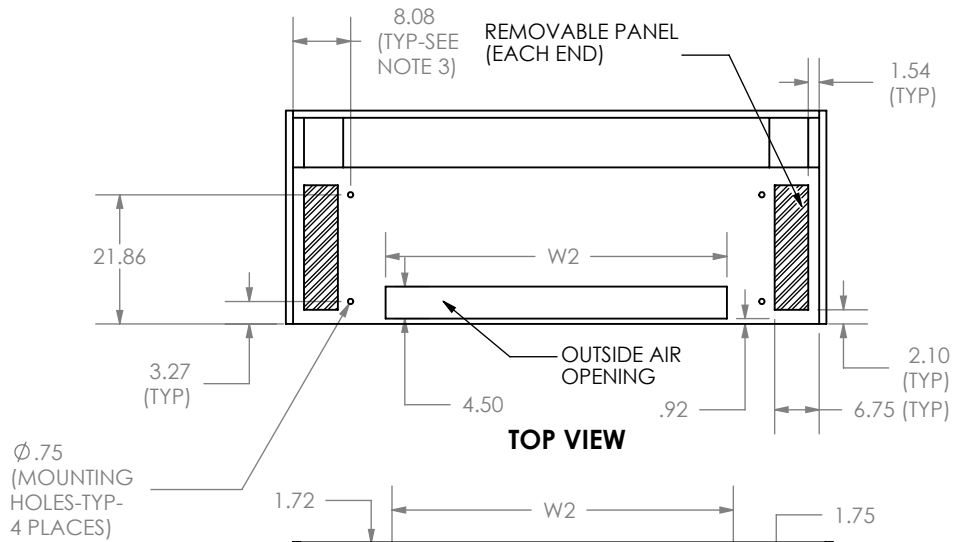

TOP VIEW

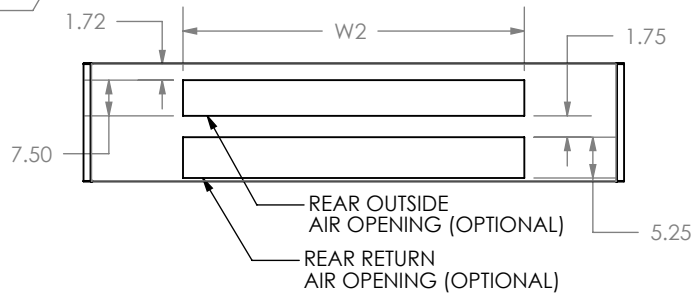

REAR VIEW

MODEL NO.	CFM	W1	W2	W3	APPROXIMATE SHIPPING WEIGHT (LBS)	APPROXIMATE INSTALLED WEIGHT (LBS)
UHF2	750	62	36	31.67	420	405
UHF3	1000	74	48	46.74	500	480
UHF4	1250	86	60	61.81	620	600
UHF5	1500	98	72	78.47	690	670

NOTE:

1. Drawing refers to Design "F" units.
2. All dimensions in inches.
3. Dimension does not include end panels.
4. Two bottom panels provided for service access.
5. Motor and electrical power input box on right side of unit. Box includes Fan Speed switch and non-fused disconnect switch.
6. Connection hand is determined by facing discharge of unit.

CODE NO.
CATALOG NO.

THIS DOCUMENT IS THE PROPERTY OF UNITED ELECTRIC CORPORATION AND IS DELIVERED UPON THE EXPRESS CONDITION THAT THE CONTENTS WILL NOT BE DISCLOSED OR USED WITHOUT UNITED ELECTRIC CORPORATION'S WRITTEN CONSENT.

SUBMISSION OF THESE DRAWINGS OR DOCUMENTS DOES NOT CONSTITUTE PART PERFORMANCE OR ACCEPTANCE OF CONTRACT.

UH HORIZONTAL UNIT VENTILATOR
MODEL UHF 6
DOWN DISCHARGE PLENUM
DOUBLE DEFLECTION GRILLE

UH
Design F

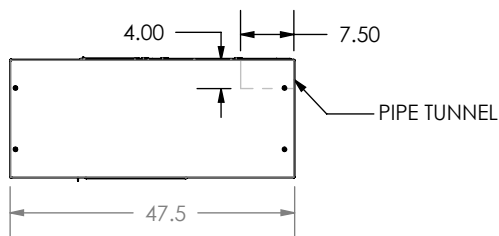

LEFT SIDE VIEW

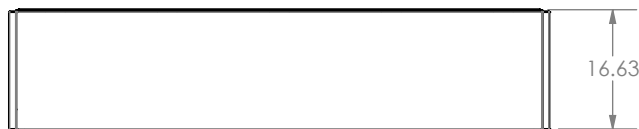

FRONT VIEW

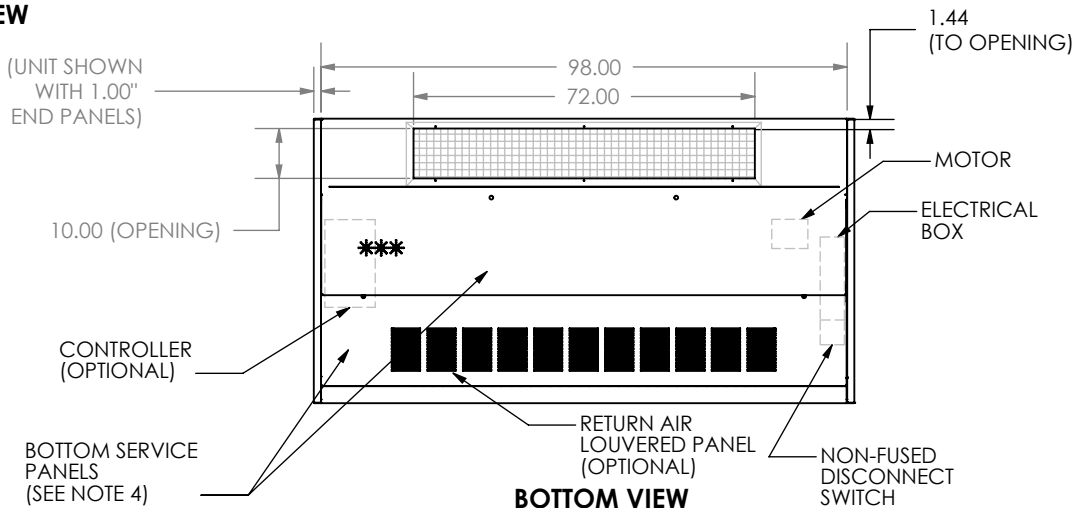

BOTTOM VIEW

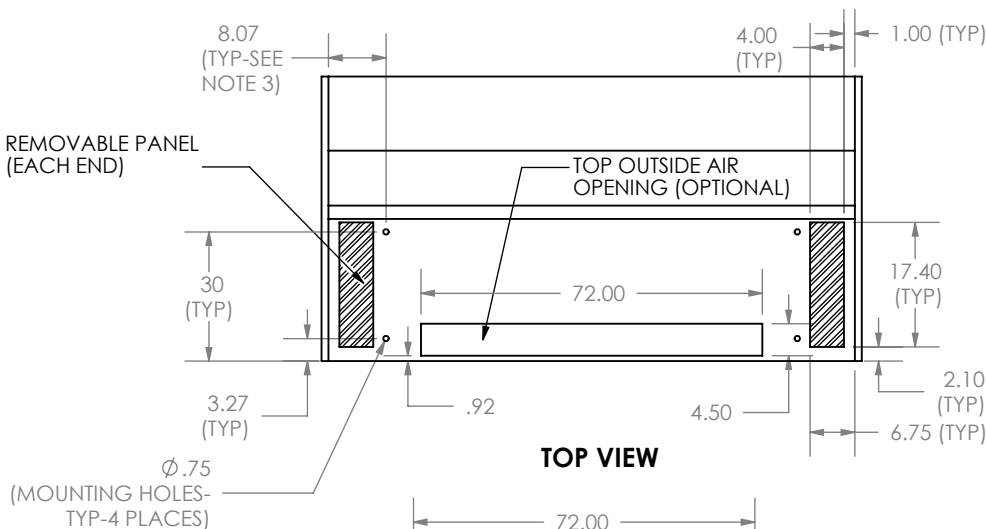

TOP VIEW

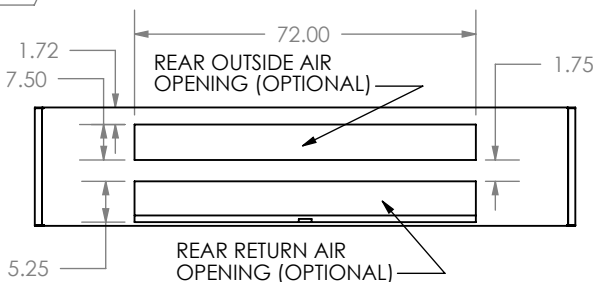

REAR VIEW

NOTE:

1. Drawing refers to Design "F" units.
2. All dimensions are in inches.
3. Dimension does not include end panels.
4. Two bottom panels provided for service access.
5. Motor and electrical power input box on right side of unit. Box includes Fan Speed switch and non-fused disconnect switch.
6. Connection hand is determined by facing discharge of unit.
7. Approx shipping weight is 1050 lbs. Approx installed weight is 1030 lbs.

PRODUCT INFORMATION IS SUBJECT TO CHANGE WITHOUT NOTICE

JOB NAME	JOB #	LOCATION	BUYER	BUYER #	DRAWING NO. UHF-304-1	REV
----------	-------	----------	-------	---------	------------------------------	-----

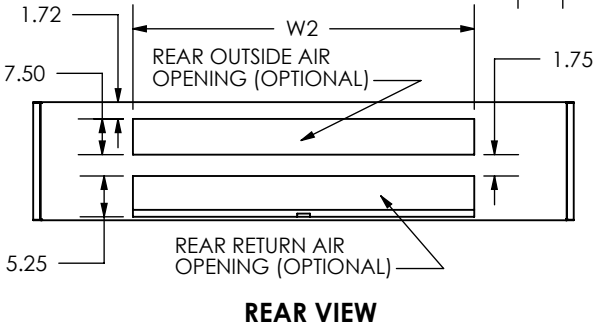
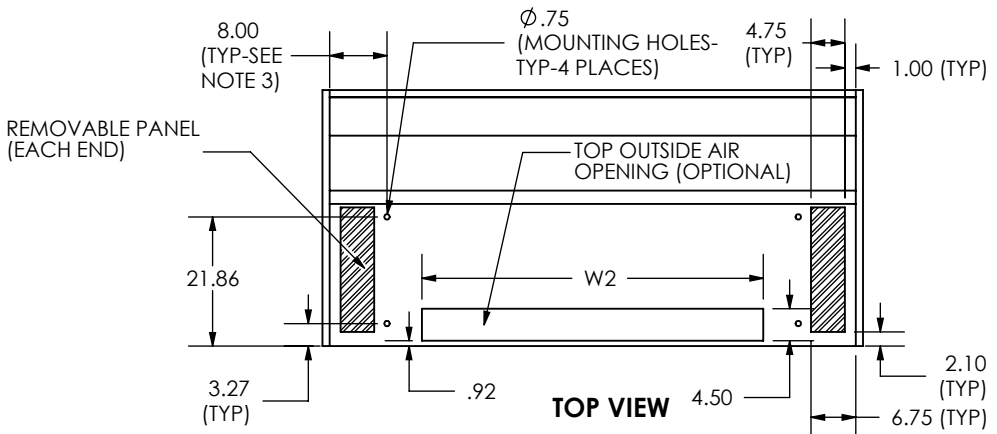
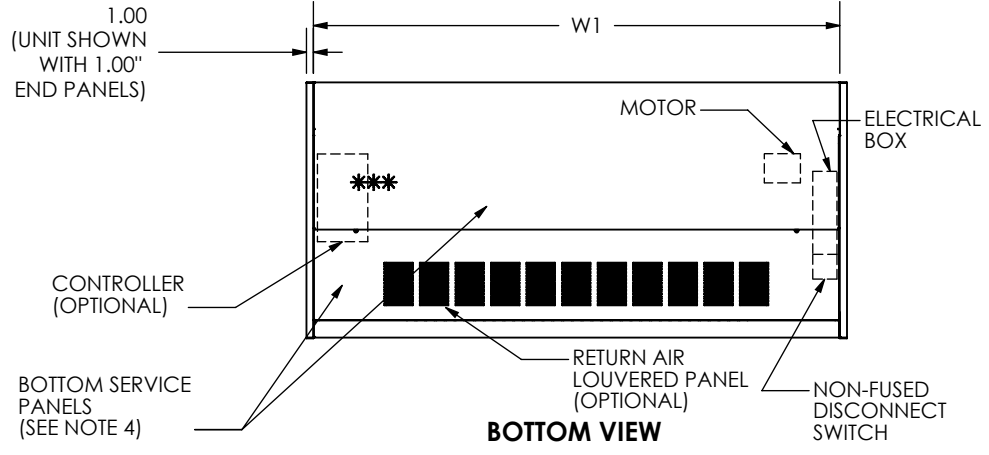
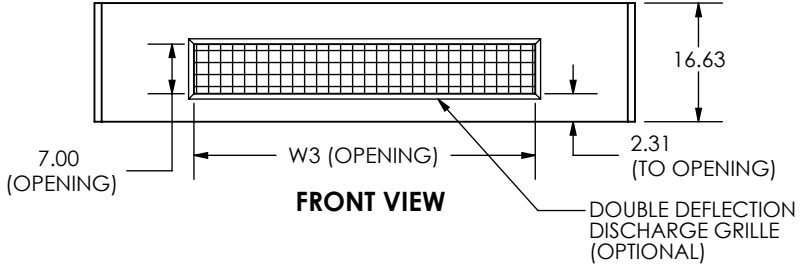
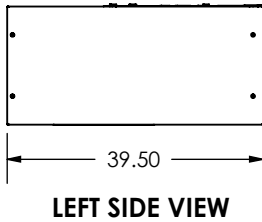

MODEL NO	CFM	W1	W2	W3	APPROXIMATE SHIPPING WEIGHT (LBS)	APPROXIMATE INSTALLED WEIGHT (LBS)
UHF2	750	62	36	36	500	485
UHF3	1000	74	48	48	600	580
UHF4	1250	86	60	60	740	720
UHF5	1500	98	72	72	830	810

- NOTE:**
1. Drawing refers to Design "F" units.
 2. All dimensions are in inches.
 3. Dimension does not include end panels.
 4. Two bottom panels provided for service access.
 5. Motor and electrical power input box on right side of unit. Box includes Fan Speed switch and non-fused disconnect switch.
 6. Connection hand is determined by facing discharge of unit.

CODE NO.
CATALOG NO.

THIS DOCUMENT IS THE PROPERTY OF UNITED ELECTRIC CORPORATION AND IS DELIVERED UPON THE EXPRESS CONDITION THAT THE CONTENTS WILL NOT BE DISCLOSED OR USED WITHOUT UNITED ELECTRIC CORPORATION'S WRITTEN CONSENT.

SUBMISSION OF THESE DRAWINGS OR DOCUMENTS DOES NOT CONSTITUTE PART PERFORMANCE OR ACCEPTANCE OF CONTRACT.

UH HORIZONTAL UNIT VENTILATOR
MODELS UHF 2 THRU 5
DOWN DISCHARGE PLENUM
DOUBLE DEFLECTION GRILLE

UH
Design F

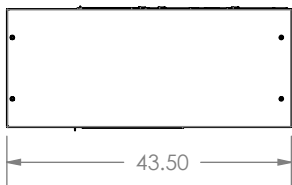

LEFT SIDE VIEW

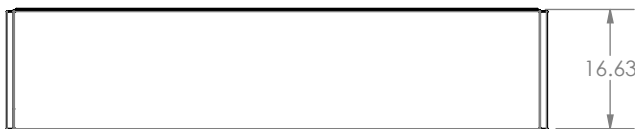

FRONT VIEW

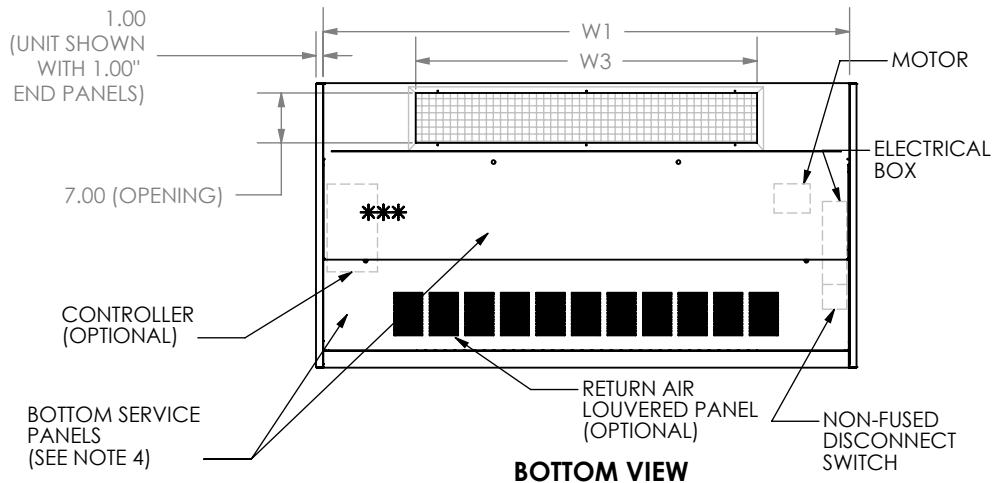

BOTTOM VIEW

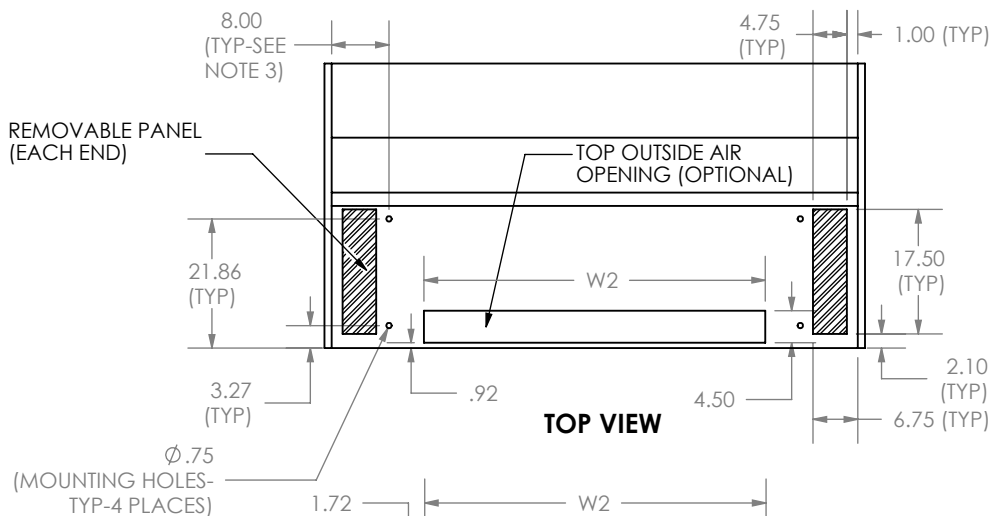

TOP VIEW

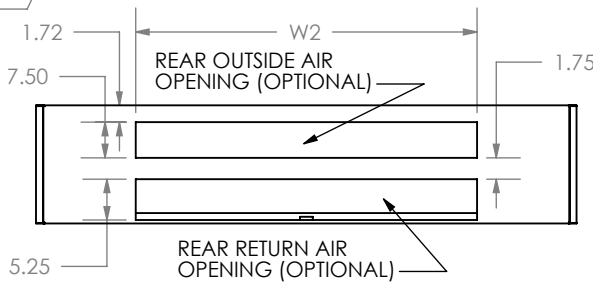

REAR VIEW

MODEL NO.	CFM	W1	W2	W3	APPROXIMATE SHIPPING WEIGHT (LBS)	APPROXIMATE INSTALLED WEIGHT (LBS)
UHF2	750	62	36	36	530	515
UHF3	1000	74	48	48	640	620
UHF4	1250	86	60	60	790	770
UHF5	1500	98	72	72	880	860

NOTE:

1. Drawing refers to Design "F" units.
2. All dimensions are in inches.
3. Dimension does not include end panels.
4. Two bottom panels provided for service access.
5. Motor and electrical power input box on right side of unit. Box includes Fan Speed switch and non-fused disconnect switch.

PRODUCT INFORMATION IS SUBJECT TO CHANGE WITHOUT NOTICE

JOB NAME	JOB #	LOCATION	BUYER	BUYER #	DRAWING NO. UHF-302-1	REV
----------	-------	----------	-------	---------	------------------------------	-----

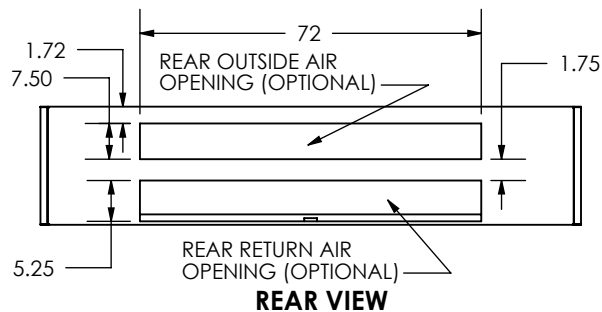
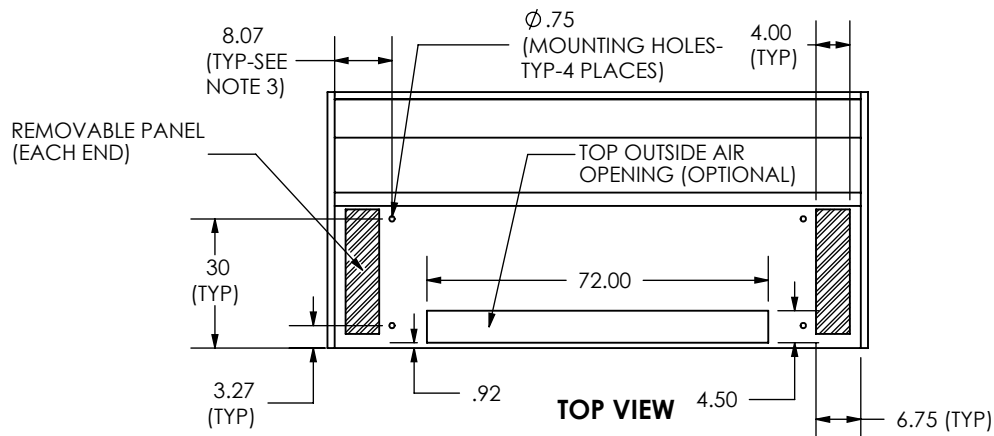
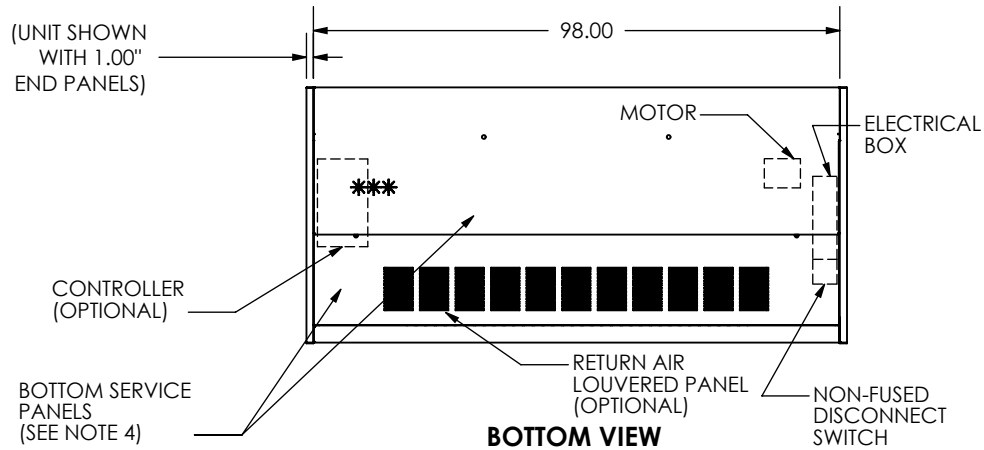
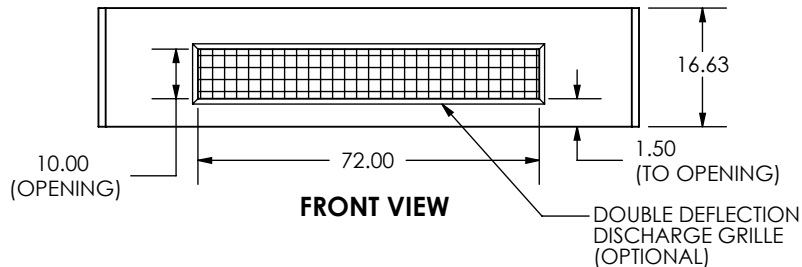
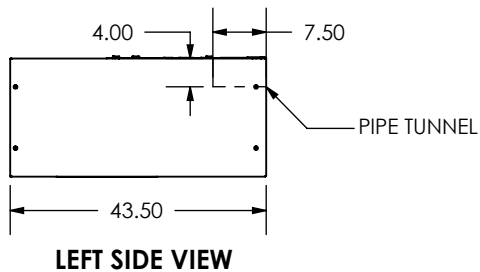

NOTE:

1. Drawing refers to Design "F" units.
2. All dimensions are in inches.
3. Dimension does not include end panels.
4. Two bottom panels provided for service access.
5. Motor and electrical power input box on right side of unit. Box includes Fan Speed switch and non-fused disconnect switch.
6. Connection hand is determined by facing discharge of unit.
7. Approx shipping weight is 1020 lbs. Approx installed weight is 1000 lbs.

PRODUCT INFORMATION IS SUBJECT TO CHANGE WITHOUT NOTICE

JOB NAME	JOB #	LOCATION	BUYER	BUYER #	DRAWING NO. UHF-303-1	REV A
----------	-------	----------	-------	---------	------------------------------	--------------